

**SANTA FE COUNTY  
BOARD OF COUNTY COMMISSIONERS**

**RESOLUTION NO. 2025 - 127**

---

**A RESOLUTION TO AMEND RESOLUTION NO. 2025-075 TO DIVIDE AND  
ADJUST THE BOUNDARIES OF PRECINCTS 56, 76, 82, 147, 151, AND 153  
PURSUANT TO NMSA 1978, SECTIONS 1-3-1 AND 1-3-5; ADJUST CERTAIN  
CONSOLIDATED PRECINCTS; AND DESIGNATE POLLING PLACES FOR  
SUCH ADJUSTED CONSOLIDATED PRECINCTS**

---

**WHEREAS**, NMSA 1978, Section 1-3-2 (2019), requires that, in June or July of each odd-numbered year, the Board of County Commissioners (Board) of Santa Fe County (County) by resolution must: (1) designate the polling place of each precinct in the County; (2) consolidate any precincts pursuant to NMSA 1978, Section 1-3-4 (2023); and (3) create additional polling places in existing precincts pursuant to NMSA 1978, Section 1-3-7.1 (1991); and

**WHEREAS**, on July 8, 2025, pursuant to NMSA 1978, Sections 1-3-2, 1-3-4, and 1-3-7.1, the Board adopted Resolution No. 2025-075 to consolidate precincts, designate the location of election day polling places in the County, and create an absentee voter precinct for the conduct of any statewide election conducted in calendar years 2026 and 2027; and

**WHEREAS**, NMSA 1978, Section 1-3-1(B) (2019) provides that “[a] precinct shall be divided or its boundaries adjusted if the precinct has had more than:

- (1) seven hundred fifty votes cast by voters of that precinct at a general election, based on the two most recent general elections; or
- (2) two thousand five hundred persons residing within the boundaries of the precinct, based on the most recent federal decennial census”; and

**WHEREAS**, pursuant to NMSA 1978, Section 1-3-5(A) (2019), the Board shall create additional precincts to meet the requirements of NMSA 1978, Section 1-3-1 by resolution; and

**WHEREAS**, pursuant to NMSA 1978, Section 1-3-5(B), any necessary precinct boundary adjustments shall be submitted to the New Mexico Secretary of State (NM SOS) no later than the first Monday in December of each odd-numbered year to become effective January 1 next succeeding the approval of the boundary adjustment; and

**WHEREAS**, Section 1-3-1(A) states that “[e]ach precinct as nearly as practicable shall be composed of congruous and compact areas having clearly definable boundaries and all boundaries shall comply with the provisions of the Precinct Boundary Adjustment Act [1-3-10 to 1-3-14 NMSA 1978]”; and

**WHEREAS**, based on voter data from the 2024 General Election, the County Clerk's Office has determined that Precincts 56, 76, 82, 147, 151, and 153 meet the criteria for dividing precincts or adjusting precinct boundaries set forth in Section 1-3-1(B), as shown in Exhibit A, attached hereto and incorporated herein; and

**WHEREAS**, the County Clerk's Office recommends that Precincts 56, 76, 82, 147, 151, and 153 each be divided, creating six new and separate precincts in accordance with Section 1-3-1(B) as follows:

- 1) Precinct 56 is divided and its boundaries are adjusted to create a new and separate Precinct 180;
- 2) Precinct 76 is divided, and its boundaries are adjusted to create a new and separate Precinct 181;
- 3) Precinct 82 is divided and its boundaries are adjusted to create a new and separate Precinct 182;
- 4) Precinct 147 is divided and its boundaries are adjusted to create a new and separate Precinct 183;
- 5) Precinct 151 is divided and its boundaries are adjusted to create a new and separate Precinct 184; and
- 6) Precinct 153 is divided and its boundaries are adjusted to create a new and separate Precinct 185; and

**WHEREAS**, Exhibits B1 through B12 and C, attached hereto and incorporated herein, depict and describe the adjusted boundaries of Precincts 56, 76, 82, 147, 151, and 153 and the boundaries of new Precincts 180, 181, 182, 183, 184, and 185; and

**WHEREAS**, NMSA 1978, Section 1-3-12(A) (2021) of the Boundary Adjustment Act requires boundaries to coincide with a feature or boundary on the standard base maps developed by the NM SOS, a designated census block boundary on the proposed federal PL 94-171 2020 census block maps; or approved by the secretary of state and the United States census bureau; and

**WHEREAS**, the boundaries of Precincts 56, 76, 82, 147, 151, 153, 180, 181, 182, 183, 184, and 185 depicted and described in Exhibits B1 through B12 and C are composed of congruous and compact areas having clearly definable boundaries that coincide with features or boundaries on the standard base maps developed by the NM SOS in compliance with Section 1-3-12(A) of the Precinct Boundary Adjustment Act; and

**WHEREAS**, in order to make voting more convenient and accessible to voters, the Board permitted voters in the County to cast ballots in statewide elections at voter convenience centers through the use of consolidated precincts pursuant to NMSA 1978, Sections 1-3-2(B) and 1-3-4 in Resolution No. 2025-075; and

**WHEREAS**, the County Clerk's Office recommends adjusting certain consolidated precincts set forth in Resolution No. 2025-075 to reflect the creation of new precincts as follows:

- 1) Consolidated Precinct No. 7, which consists of Precincts 20, 21, 95, 121, 158, and 172, is adjusted to include Precincts 147, 169, and 183;
- 2) Consolidated Precinct No. 8, which consists of Precincts 82, 83, 90, 146, 147, 152, 153, 169, and 177, is adjusted to 1) remove Precincts 147 and 169 and 2) include Precincts 182 and 185; and
- 3) Consolidated Precinct No. 15, which consists of Precincts 35, 50, 51, 76, 77, 117, and 124, is adjusted to include Precincts 173 and 181;
- 4) Consolidated Precinct No. 17, which consists of Precincts 29, 38, 39, 49, 56, 96, 99, 105, 133, and 173, is adjusted to 1) remove Precinct 173 and 2) include Precinct 180;
- 5) Consolidated Precinct No. 20, which consists of Precincts 12, 62, 89, 93, 149, 151, 154, 170, and 176, is adjusted to include Precinct 184; and

**WHEREAS**, Voter Convenience Centers (VCCs) for the adjusted consolidated precincts will need to be designated by this resolution; and

**WHEREAS**, because all adjustments are made to existing consolidated precincts, the County Clerk's Office is not recommending any new or different VCCs to those set forth in Resolution No. 2025-075; and

**WHEREAS**, the Board finds that those precincts that are consolidated to create VCCs meet the requirements of NMSA 1978, Sections 1-3-4 and 1-3-7 (2019), will be available to voters of any precinct in the county to cast a vote at the VCC, will make voting more convenient and accessible to voters of the consolidated precinct, will not result in delays for voters in the voting process, shall have a broadband internet connection and real-time access to the state-wide voter registration electronic management system, and are centrally located within the consolidated precinct; and

**WHEREAS**, the Board finds that each polling place designated in this resolution complies with the provisions of NMSA 1978, Section 1-3-7; and

**WHEREAS**, for those consolidated precincts with more than one polling place, the Board finds that the interest of the convenience of the voters and providing accessibility to the polling place justifies the creation of additional polling places within the consolidated precinct; and

**WHEREAS**, the Board finds that none of the consolidated precincts adjusted herein are composed of more than ten precincts; and

**WHEREAS**, the Board of County Commissioners finds that each polling place set forth herein provides individuals with physical mobility limitations an unobstructed access to at least one voting machine.

**NOW, THEREFORE, BE IT RESOLVED** by the Santa Fe County Board of County Commissioners amends Resolution No. 2025-075 as follows:

**Section 1.** Section 1 is hereby deleted and replaced with following:

**“Section 1. Creation of New Precincts, Adjustment of Existing Precinct Boundaries, and Consolidation of Precincts:**

A. As set forth in attached Exhibits B1 through B12 and C, new precincts are hereby created, and the boundaries of existing precincts are hereby adjusted in accordance with Section 1-3-1(B) as follows:

- 1) Precinct 56 is divided and its boundaries are adjusted to create a new and separate Precinct 180;
- 2) Precinct 76 is divided, and its boundaries are adjusted to create a new and separate Precinct 181;
- 3) Precinct 82 is divided and its boundaries are adjusted to create a new and separate Precinct 182;
- 4) Precinct 147 is divided and its boundaries are adjusted to create a new and separate Precinct 183;
- 5) Precinct 151 is divided and its boundaries are adjusted to create a new and separate Precinct 184; and
- 6) Precinct 153 is divided and its boundaries are adjusted to create a new and separate Precinct 185; and

B. Precincts in Santa Fe County shall be consolidated as set forth hereafter in Section 2 of this Resolution, Designation of Polling Locations. Any voter may vote in any consolidated precinct in Santa Fe County, regardless of precinct in which the voter resides.”

**Section 2. Amendments to Section 2(A), Polling Locations for All Statewide Elections of Resolution No. 2025-075.** The rows of the table in Section 2(A), Polling Locations for All Statewide Elections, of Resolution No. 2025-075 are hereby amended to adjust consolidated precincts and designate the polling places/voter convenience centers within such adjusted consolidated precincts are amended as follows:

1. The row regarding Consolidated Precinct No. 7 is deleted and replaced with the following:

7	20, 21, 95, 121, 147, 158, 169, 172, 183	Tesuque Elementary School 1555 Bishop's Lodge Rd.
---	--	--

SFC CLERK RECORDED 12/02/2025

2. The row regarding Consolidated Precinct No. 8 is deleted and replaced with the following:

8	82, 83, 90, 146, 152, 153, 177, 182, 185	Unity Santa Fe 1212 Unity Way
---	--	----------------------------------

3. The row regarding Consolidated Precinct No. 15 is deleted and replaced with the following:

15	35, 50, 51, 76, 77, 117, 124, 173, 181	Chaparral Elementary School 2451 Avenida Chaparral
----	--	---

4. The row regarding Consolidated Precinct No. 17 is deleted and replaced with the following:

17	29, 38, 39, 49, 56, 96, 99, 105, 133, 180	Santa Fe County Fair Building 3229 Rodeo Road  <i>and/or</i>  Monte Del Sol Charter School 4157 Walking Rain Rd  <i>provided that</i> the County Clerk publishes a notice, more than 120 days before any statewide election, indicating which polling place(s) will be used in such statewide election
----	---	--

5. The row regarding Consolidated Precinct No. 20 is deleted and replaced with the following:

20	12, 62, 89, 93, 149, 151, 154, 170, 146, 184	La Cienega Community Center 136 Camino San Jose
----	--	--

**Section 3.** Except for those amendments set forth above, all other provisions set forth in Resolution No. 2025-075 shall remain in effect.

**BE IT FURTHER RESOLVED** that pursuant to NMSA 1978, Section 1-3-8 (2023), upon adoption of this Resolution, the County Clerk shall send a certified copy of this Resolution to the Secretary of State and to the County Chair of each of the major

political parties and shall publish the resolution once in a newspaper as provided in NMSA 1978, Section 1-1-14 (2011).

PASSED, APPROVED, AND ADOPTED THIS 1<sup>st</sup> DAY OF NOVEMBER, 2025.

SANTA FE COUNTY  
BOARD OF COUNTY COMMISSIONERS

By: *Camilla Bustamante*  
Camilla Bustamante, Chair

ATTEST:

*Katharine E. Clark*  
Katharine E. Clark  
Santa Fe County Clerk

Date: 12/2/2025

Approved as to form:

*Cristella Cole* for  
Walker Boyd  
Santa Fe County Attorney

SFC CLERK RECORDED 12/02/2025



COUNTY OF SANTA FE )  
STATE OF NEW MEXICO ) ss

BCC RESOLUTIONS  
PAGES: 27

Hereby Certify That This Instrument Was Filed for  
Record On The 2ND Day Of December, 2025 at 03:48:12 PM  
and Was Duly Recorded as Instrument # 2072535  
of The Records Of Santa Fe County

Witness My Hand And Seal Of Office  
Katharine E. Clark  
Deputy *Serena Barera* County Clerk, Santa Fe, NM

**Justin S. Greene**  
*Commissioner, District 1*

**Lisa Cacari Stone**  
*Commissioner, District 2*

**Camilla Bustamante**  
*Commissioner, District 3*



**Adam Fulton Johnson**  
*Commissioner, District 4*

**Hank Hughes**  
*Commissioner, District 5*

**Gregory S. Shaffer**  
*County Manager*

## MEMORANDUM

**Date:** November 12, 2025

**To:** Board of County Commissioners

**From:** Katharine Clark, Santa Fe County Clerk  
Rosangela Ortiz, Chief Deputy- Bureau of Elections

**Via:** Gregory S. Shaffer, County Manager  
Elias Bernadino, Deputy County Manager

**Subject:** **November 19, 2025, Special BCC Meeting**  
Resolution No. 2025-\_\_\_\_, A Resolution to Amend Resolution No. 2025-075 to Divide and Adjust the Boundaries of Precincts 56, 76, 82, 147, 151, and 153 Pursuant to NMSA 1978, Sections 1-3-1 and 1-3-5; Adjust Certain Consolidated Precincts; and Designate Polling Places for Such Adjusted Consolidated Precincts

### **SUMMARY:**

The Santa Fe County (County) Clerk's Office requests approval of A Resolution to Amend Resolution No. 2025-075 to Divide and Adjust the Boundaries of Precincts 56, 76, 82, 147, 151, and 153 Pursuant to NMSA 1978, Sections 1-3-1 and 1-3-5; Adjust Certain Consolidated Precincts; and Designate Polling Places for Such Adjusted Consolidated Precincts.

### **BACKGROUND:**

#### *Resolution No. 2025-075 – Consolidation of Precincts and Designation of Polling Places*

NMSA 1978, Section 1-3-2 (2019), requires that, in June or July of each odd-numbered year, the Board of County Commissioners (Board) by resolution must: (1) designate the polling place of each precinct in the County; (2) consolidate any precincts pursuant to NMSA 1978, Section 1-3-4 (2023); and (3) create additional polling places in existing precincts pursuant to NMSA 1978, Section 1-3-7.1 (1991). On July 8, 2025, pursuant to NMSA 1978, Sections 1-3-2, 1-3-4, and 1-3-7.1, the Board adopted Resolution No. 2025-075 to consolidate precincts, designate the location of election day polling places in the County, and create an absentee voter precinct for the conduct of any statewide election conducted in calendar years 2026 and 2027.

*Division of Precincts*

The County Clerk's Office has determined that state law requires the division of seven County precincts. NMSA 1978, Section 1-3-1(B) (2019) provides that "[a] precinct shall be divided or its boundaries adjusted if the precinct has had more than:

- (1) seven hundred fifty votes cast by voters of that precinct at a general election, based on the two most recent general elections; or
- (2) two thousand five hundred persons residing within the boundaries of the precinct, based on the most recent federal decennial census."

Based on voter data from the 2024 General Election, the County Clerk's Office has determined that Precincts 56, 76, 82, 147, 151, and 153 meet the criteria for dividing precincts or adjusting precinct boundaries set forth in Section 1-3-1(B). The Board has already divided precincts where more than 750 votes were cast in the 2022 General Election in Resolution No. 2023-067.

The County Clerk's Office recommends that Precincts 56, 76, 82, 147, 151, and 153 each be divided creating six new and separate precincts in accordance with Section 1-3-1(B) as follows:

- 1) Precinct 56 is divided and its boundaries are adjusted to create a new and separate Precinct 180;
- 2) Precinct 76 is divided, and its boundaries are adjusted to create a new and separate Precinct 181;
- 3) Precinct 82 is divided and its boundaries are adjusted to create a new and separate Precinct 182;
- 4) Precinct 147 is divided and its boundaries are adjusted to create a new and separate Precinct 183;
- 5) Precinct 151 is divided and its boundaries are adjusted to create a new and separate Precinct 184; and
- 6) Precinct 153 is divided and its boundaries are adjusted to create a new and separate Precinct 185.

Precinct divisions or boundary adjustments must be done by resolution and submitted to the New Mexico Secretary of State by December 1, 2025, to become effective January 1, 2026. NMSA 1978, 1-3-5 (2019)

#### *Proposed Precinct Boundaries*

The County Clerk's Office worked with Research & Polling, Inc. to propose boundaries for the precincts that are being divided and the newly created precincts that are both logical and ensure compliance with the voter volumes set forth in Section 1-3-1(B) of the Election Code. Accordingly, the County Clerk's Office and Research & Polling included an evaluation of future growth in proposing the new boundaries.

The precinct boundaries must comply with the provisions of the Precinct Boundary Adjustment Act, NMSA 1978, Sections 1-3-10 to 1-3-14. NMSA 1978, Section 1-3-12(A) of the Boundary Adjustment Act requires boundaries to coincide with a feature or boundary on the standard base maps developed by the NM SOS, a designated census block boundary on the proposed federal PL 94-171 2020 census block maps; or approved by the secretary of state and the United States census bureau. The boundaries of

Precincts 56, 76, 82, 147, 151, 153, 180, 181, 182, 183, 184, and 185 coincide with features or boundaries on the standard base maps developed by the NM SOS in compliance with Section 1-3-12(A) of the Precinct Boundary Adjustment Act.

### *Consolidation of Precincts*

In order to make voting more convenient and accessible to voters, the Board permitted voters in the County to cast ballots in statewide elections at voter convenience centers through the use of consolidated precincts pursuant to NMSA 1978, Sections 1-3-2(B) and 1-3-4 in Resolution No. 2025-075. The proposed amendments to Resolution No. 2025-075 would adjust consolidated precincts to include Precincts 180, 181, 182, 183, 184, and 185.

The County Clerk's Office recommends adjusting certain consolidated precincts set forth in Resolution No. 2025-075 as follows:

- 1) Consolidated Precinct No. 7, which consists of Precincts 20, 21, 95, 121, 158, and 172, is adjusted to include Precincts 147, 169, and 183;
- 2) Consolidated Precinct No. 8, which consists of Precincts 82, 83, 90, 146, 147, 152, 153, 169, and 177, is adjusted to 1) remove Precincts 147 and 169 and 2) include Precincts 182 and 183 and
- 3) Consolidated Precinct No. 15, which consists of Precincts 35, 50, 51, 76, 77, 117, and 124, adjusted to include Precincts 173 and 181;
- 4) Consolidated Precinct No. 17, which consists of Precincts 29, 38, 39, 49, 56, 96, 99, 105, 131, and 173, is adjusted to 1) remove Precinct 173 and 2) include Precinct 180;
- 5) Consolidated Precinct No. 20, which consists of Precincts 12, 62, 89, 93, 149, 151, 154, 173, and 176, is adjusted to include Precinct 184; and

Voter Convenience Centers (VCCs) for the adjusted consolidated precincts will need to be designated by the subject resolution. Because all adjustments are made to existing consolidated precincts, the County Clerk's Office is not recommending any new or different VCCs to those set forth in Resolution No. 2025-075.

### **RECOMMENDED ACTION:**

Approve the subject resolution to amend Resolution No. 2025-075 to Divide and Adjust the Boundaries of Precincts 56, 76, 82, 147, 151, and 153 Pursuant to NMSA 1978, Sections 1-3-1 and 1-3-5; Adjust Certain Consolidated Precincts; and Designate Polling Places for Such Adjusted Consolidated Precincts.

### **EXHIBIT:**

- Exhibit A – Subject Resolution

SEFC CLERK RECORDED 12/02/2025

**Santa Fe County****Countywide****EXHIBIT  
A**Ballots Cast Summary of General Election Held on November 5, 2024  
State of New Mexico

Precinct	Absentee	Early	Election Day	Hand	Provisionals	Total Ballots Cast
PRECINCT 001	35	238	155	9	0	437
PRECINCT 002	15	115	66	0	0	196
PRECINCT 003	41	144	201	0	2	388
PRECINCT 004	43	190	16	4	0	253
PRECINCT 005	40	413	171	4	0	628
PRECINCT 006	1	15	152	0	0	168
PRECINCT 007	45	203	153	8	0	409
PRECINCT 008	83	288	153	13	0	537
PRECINCT 009	94	320	98	21	0	533
PRECINCT 010	119	360	55	23	1	558
PRECINCT 011	78	300	115	3	0	496
PRECINCT 012	60	300	249	4	1	614
PRECINCT 013	75	350	142	8	1	576
PRECINCT 014	26	101	74	1	0	202
PRECINCT 015	42	252	40	2	0	336
PRECINCT 016	40	197	45	3	0	285
PRECINCT 017	35	167	139	11	0	352
PRECINCT 018	37	237	58	1	0	333
PRECINCT 019	30	80	80	1	0	191
PRECINCT 020	82	296	83	11	0	472
PRECINCT 021	49	254	73	10	0	386
PRECINCT 022	79	378	63	14	1	535
PRECINCT 023	55	385	175	6	0	621
PRECINCT 024	56	203	78	0	0	337
PRECINCT 025	76	294	138	19	1	528
PRECINCT 026	45	243	63	8	0	359
PRECINCT 027	46	285	86	2	1	420
PRECINCT 028	104	367	45	10	0	526
PRECINCT 029	85	432	94	5	0	616
PRECINCT 030	97	394	60	17	0	568
PRECINCT 031	39	192	96	3	0	330
PRECINCT 032	94	360	190	8	2	654
PRECINCT 033	27	170	65	6	0	268
PRECINCT 034	69	297	161	5	0	532
PRECINCT 035	32	166	37	4	1	240
PRECINCT 036	100	276	55	11	0	442
PRECINCT 037	73	254	81	6	0	414
PRECINCT 038	133	412	120	10	1	676
PRECINCT 039	70	278	120	2	0	470
PRECINCT 040	15	64	193	0	0	272
PRECINCT 041	30	182	118	0	0	330
PRECINCT 042	79	345	124	8	0	556
PRECINCT 043	92	363	114	17	0	586
PRECINCT 044	45	288	61	14	0	408
PRECINCT 045	75	272	91	18	0	456
PRECINCT 046	72	213	63	12	0	360
PRECINCT 047	74	272	66	20	0	432

SFC CLERK RECORDED 12/02/2025

**Santa Fe County****Countywide**

Ballots Cast Summary of General Election Held on November 5, 2024  
State of New Mexico

Precinct	Absentee	Early	Election Day	Hand	Provisionals	Total Ballots Cast
PRECINCT 048	50	240	86	17	0	393
PRECINCT 049	77	365	147	3	0	592
PRECINCT 050	76	463	165	14	0	718
PRECINCT 051	54	176	55	4	0	289
PRECINCT 052	28	259	124	6	1	418
PRECINCT 053	64	299	66	11	0	440
PRECINCT 054	92	434	104	5	0	635
PRECINCT 055	124	491	91	19	0	725
PRECINCT 056	180	622	176	8	2	988
PRECINCT 057	75	312	270	11	0	668
PRECINCT 058	48	337	193	1	0	579
PRECINCT 059	55	432	232	4	0	723
PRECINCT 060	17	164	103	1	0	285
PRECINCT 061	31	260	160	0	0	451
PRECINCT 062	29	199	124	1	0	353
PRECINCT 063	94	319	56	10	2	481
PRECINCT 064	31	124	108	1	0	264
PRECINCT 065	110	357	38	9	0	514
PRECINCT 066	27	248	139	0	0	414
PRECINCT 067	17	85	103	0	0	205
PRECINCT 068	87	255	58	15	0	415
PRECINCT 069	92	429	56	11	0	588
PRECINCT 070	145	450	144	3	0	742
PRECINCT 071	44	182	22	5	0	253
PRECINCT 072	75	249	243	11	1	579
PRECINCT 073	81	540	100	3	0	724
PRECINCT 074	103	424	142	4	0	673
PRECINCT 075	35	223	158	1	0	417
PRECINCT 076	91	503	150	9	0	753
PRECINCT 077	69	365	117	7	0	558
PRECINCT 078	78	341	75	11	0	505
PRECINCT 079	32	253	148	0	0	433
PRECINCT 080	34	269	188	1	1	493
PRECINCT 081	103	444	85	5	1	638
PRECINCT 082	227	422	124	5	0	778
PRECINCT 083	126	379	85	16	0	606
PRECINCT 084	91	502	119	5	0	717
PRECINCT 085	71	471	145	2	0	689
PRECINCT 086	57	312	96	3	1	469
PRECINCT 087	11	99	128	1	0	239
PRECINCT 088	74	276	191	4	0	545
PRECINCT 089	102	444	166	4	0	716
PRECINCT 090	119	382	80	7	0	588
PRECINCT 091	88	292	55	11	0	446
PRECINCT 092	93	468	154	12	0	727
PRECINCT 093	33	246	230	4	1	514
PRECINCT 094	93	314	89	16	0	512

SFC CLERK RECORDED 12/02/2025

**Santa Fe County****Countywide**

Ballots Cast Summary of General Election Held on November 5, 2024  
State of New Mexico

Precinct	Absentee	Early	Election Day	Hand	Provisionals	Total Ballots Cast
PRECINCT 095	77	250	49	4	0	380
PRECINCT 096	39	159	30	6	0	234
PRECINCT 097	61	314	123	11	0	509
PRECINCT 098	67	274	106	5	0	452
PRECINCT 099	81	325	146	0	0	552
PRECINCT 100	66	235	72	14	0	387
PRECINCT 101	100	278	114	1	0	493
PRECINCT 102	96	386	70	15	0	567
PRECINCT 103	127	385	93	11	0	616
PRECINCT 104	139	476	87	23	0	725
PRECINCT 105	92	404	92	8	0	596
PRECINCT 106	57	270	149	0	0	476
PRECINCT 107	108	449	72	14	0	643
PRECINCT 108	39	216	98	4	2	359
PRECINCT 109	60	253	93	3	0	409
PRECINCT 110	92	472	41	11	0	616
PRECINCT 111	118	294	52	12	0	476
PRECINCT 112	63	274	152	1	0	490
PRECINCT 113	105	407	42	17	0	571
PRECINCT 114	113	283	149	12	0	557
PRECINCT 115	51	511	68	5	0	635
PRECINCT 116	34	189	166	3	0	392
PRECINCT 117	60	323	118	5	0	506
PRECINCT 118	34	250	140	0	0	424
PRECINCT 119	59	184	68	10	0	321
PRECINCT 120	84	237	56	12	0	389
PRECINCT 121	65	231	122	12	0	430
PRECINCT 122	34	204	76	5	0	319
PRECINCT 123	58	200	53	11	0	322
PRECINCT 124	42	252	55	8	0	357
PRECINCT 125	77	476	110	4	0	667
PRECINCT 126	51	133	182	0	0	366
PRECINCT 127	47	196	42	3	0	288
PRECINCT 128	53	293	132	2	0	480
PRECINCT 129	64	325	73	15	0	477
PRECINCT 130	72	326	95	9	0	502
PRECINCT 131	68	297	47	15	0	427
PRECINCT 132	84	245	83	13	0	425
PRECINCT 133	42	222	93	0	0	357
PRECINCT 134	96	512	62	13	0	683
PRECINCT 135	63	274	168	0	0	505
PRECINCT 136	51	175	89	0	2	317
PRECINCT 137	32	211	92	3	0	338
PRECINCT 138	54	208	134	2	0	398
PRECINCT 139	82	429	53	8	0	572
PRECINCT 140	35	166	99	1	0	301
PRECINCT 141	29	138	91	2	0	260

SFC CLERK RECORDED 12/02/2025

**Santa Fe County****Countywide**Ballots Cast Summary of General Election Held on November 5, 2024  
State of New Mexico

Precinct	Absentee	Early	Election Day	Hand	Provisionals	Total Ballots Cast
PRECINCT 142	98	340	48	4	0	490
PRECINCT 143	52	251	43	2	0	348
PRECINCT 144	72	345	70	2	0	489
PRECINCT 145	10	80	95	2	1	188
PRECINCT 146	171	323	88	16	0	598
PRECINCT 147	180	488	64	26	0	758
PRECINCT 148	83	418	120	2	0	623
PRECINCT 149	49	289	109	1	0	448
PRECINCT 150	76	234	136	4	0	450
PRECINCT 151	95	552	222	5	0	874
PRECINCT 152	112	246	53	5	0	416
PRECINCT 153	193	471	107	9	0	780
PRECINCT 154	55	229	220	1	0	505
PRECINCT 155	52	161	41	5	0	259
PRECINCT 156	84	275	35	3	0	397
PRECINCT 157	35	421	120	3	0	579
PRECINCT 158	56	215	60	17	0	348
PRECINCT 159	53	297	92	5	0	447
PRECINCT 160	64	330	121	13	0	528
PRECINCT 161	64	256	38	11	0	369
PRECINCT 162	53	301	63	16	0	433
PRECINCT 163	42	152	41	10	0	245
PRECINCT 164	43	160	53	2	0	258
PRECINCT 165	59	235	42	4	0	340
PRECINCT 166	89	345	96	1	0	531
PRECINCT 167	82	337	52	5	0	476
PRECINCT 168	84	315	25	7	0	431
PRECINCT 169	33	79	19	5	0	136
PRECINCT 170	41	293	111	2	0	447
PRECINCT 171	52	202	54	8	1	317
PRECINCT 172	92	238	95	11	0	436
PRECINCT 173	87	321	75	11	0	494
PRECINCT 174	62	288	220	2	1	573
PRECINCT 175	103	358	98	7	2	568
PRECINCT 176	47	244	103	2	0	396
PRECINCT 177	96	227	70	6	0	399
PRECINCT 178	50	164	99	3	1	317
PRECINCT 179	10	72	53	0	0	135
	12365	52088	18411	1234	32	84130

SFC CLERK RECORDED 12/02/2025

# Precinct 56 (split from 56)

EXHIBIT  
B1

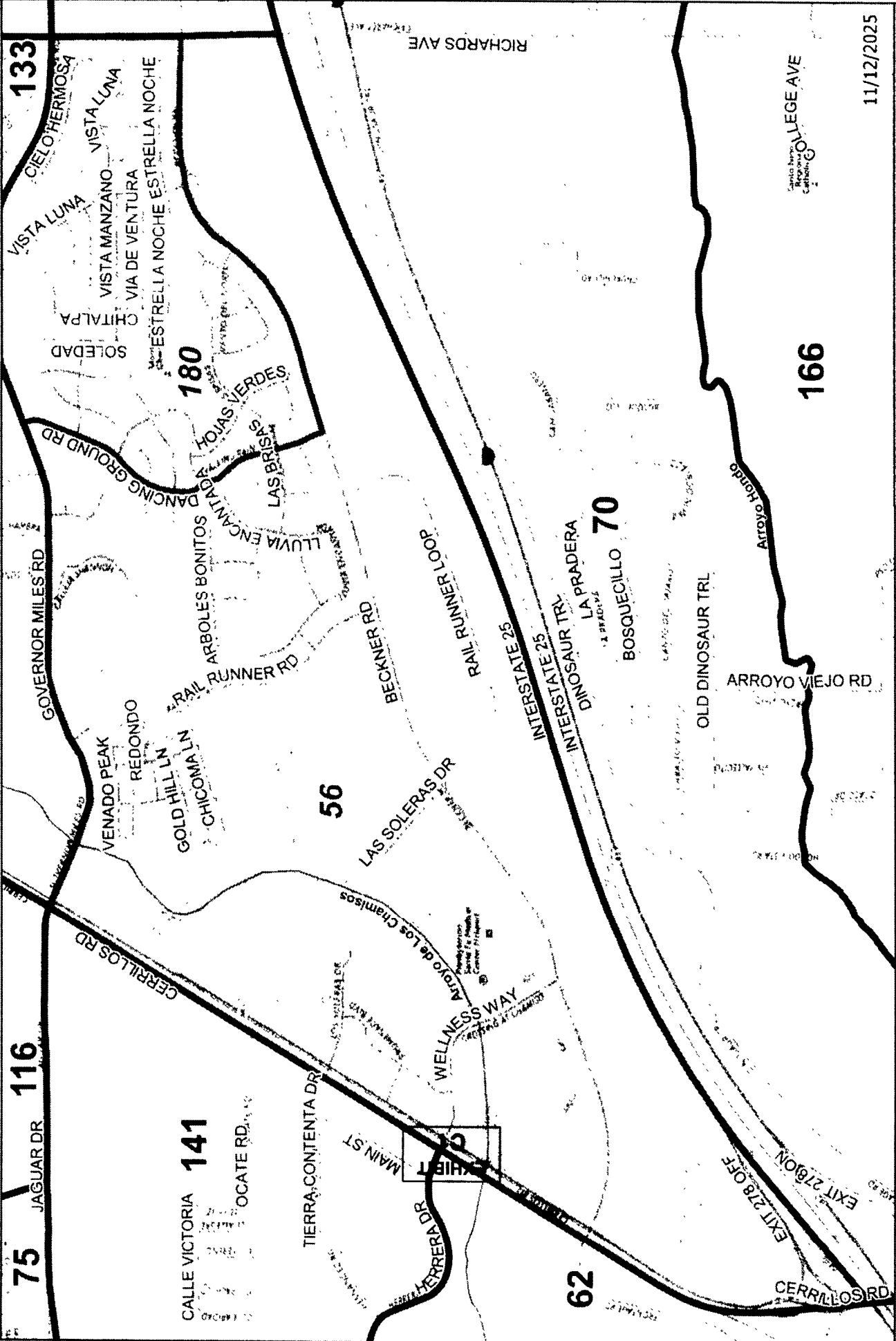

11/12/2025

SFC CLERK RECORDED 12/02/2025

Proposed Precincts

Information shown on this map is compiled from numerous sources and is not guaranteed to be complete or accurate. Research & Planning, Inc. disclaims any liability for any errors, omissions, or inaccuracies in the information provided regardless of the cause.



# Precinct 180 (split from 56)

EXHIBIT  
B2

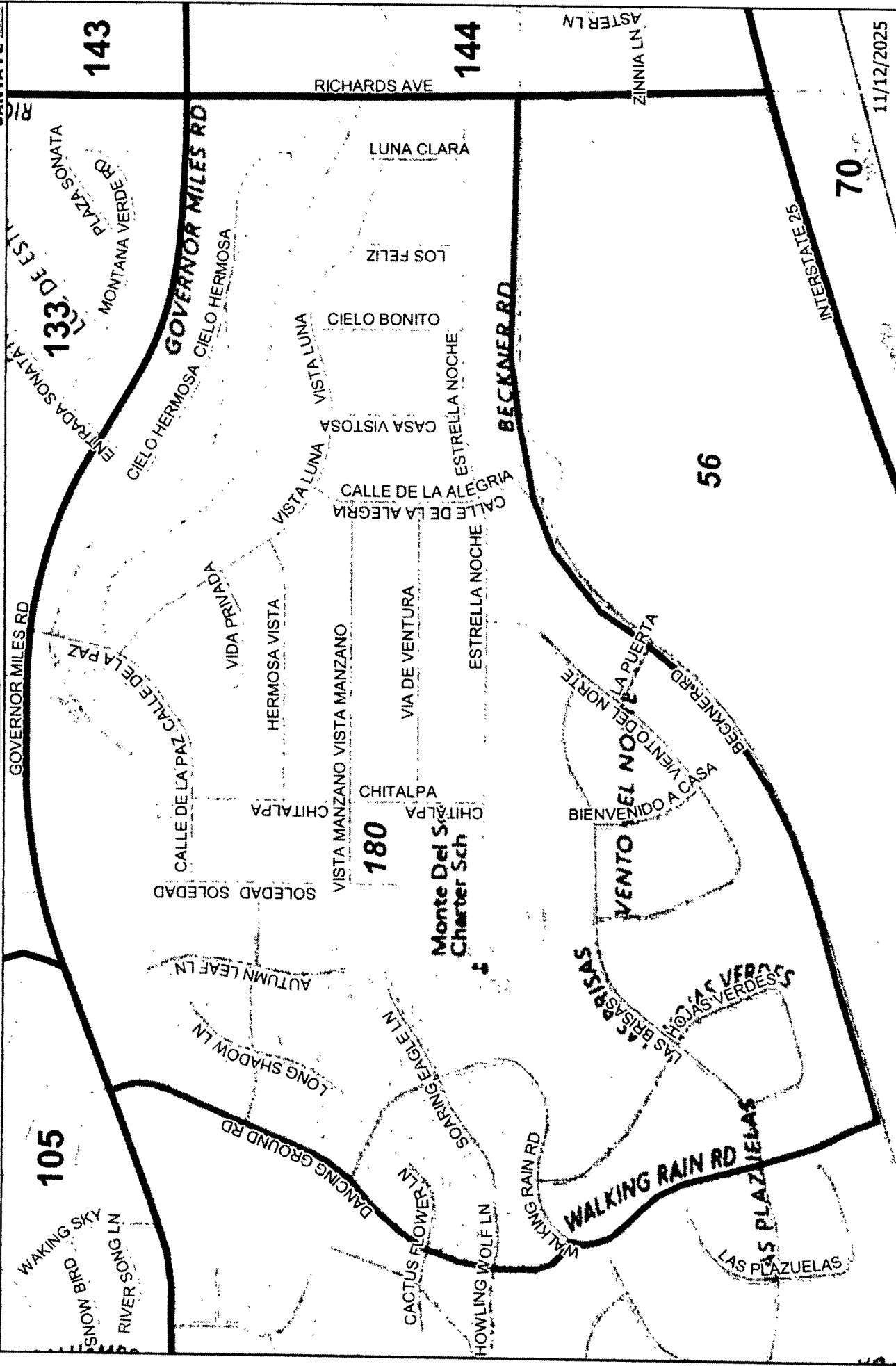

# Precinct 76 (split from 76)

EXHIBIT  
B3

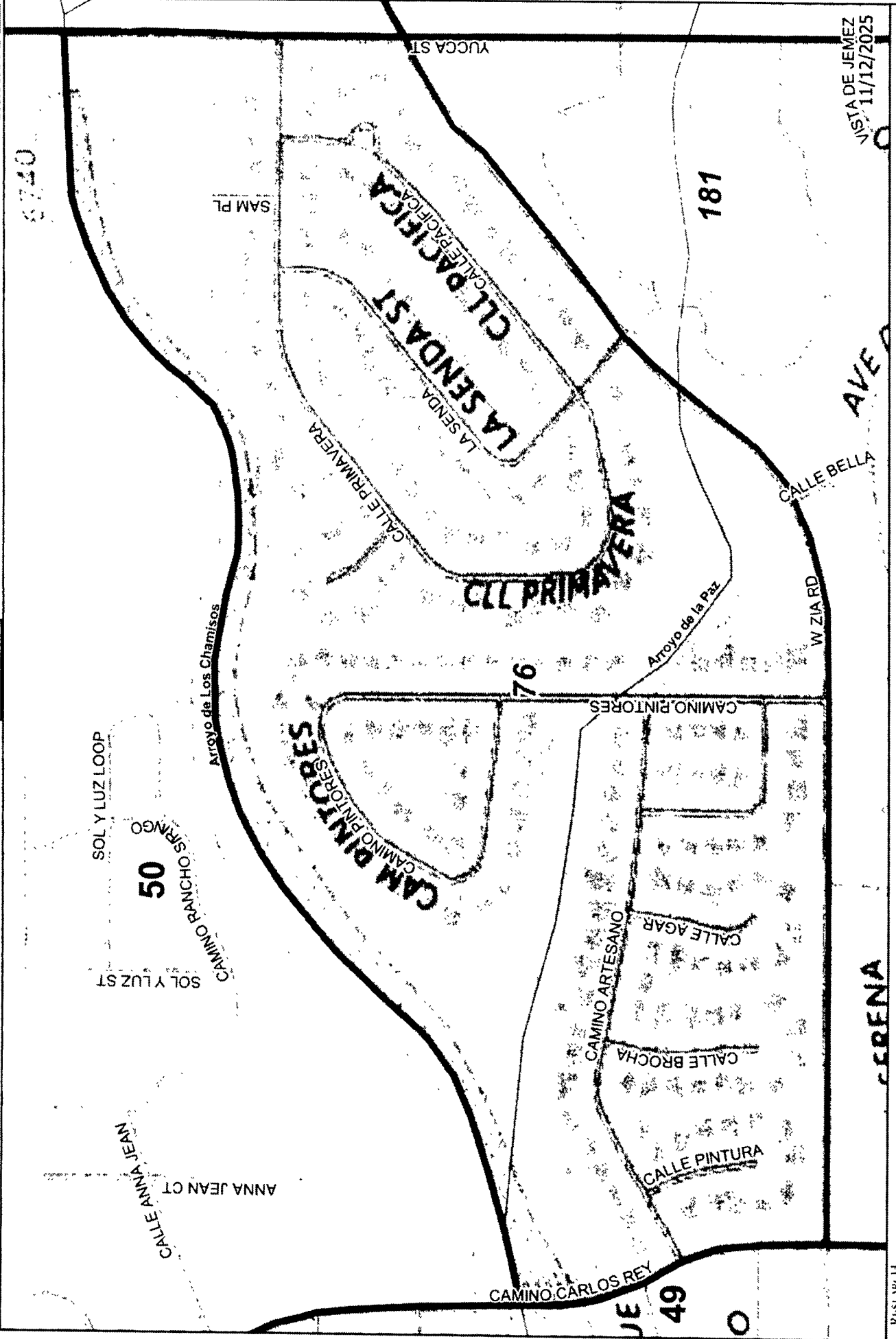

RESEARCH  
POLING  
SFC CLERK RECORDED 12/02/2023

Information shown on this map is compiled from numerous sources and is not guaranteed to be complete or accurate. Research & Poling, Inc. distributes this map assuming no liability for any error, omissions, or inaccuracies in the information provided regardless of the cause.

Proposed Precincts



VISTA DE JEMEZ  
11/12/2025

Precinct 181 (split from 76)

EXHIBIT  
B4

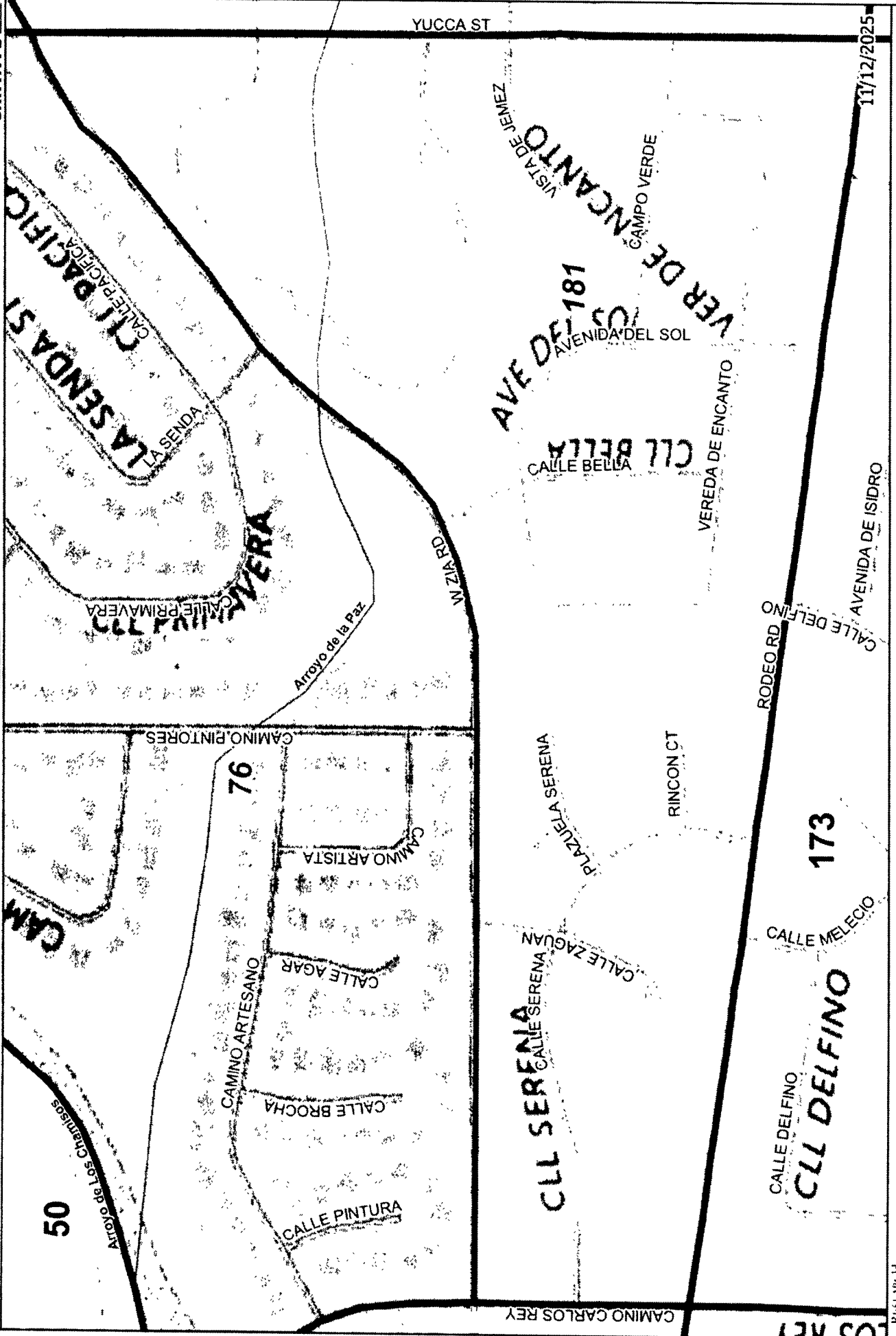

SEC CLERK RECORDED 12/02/2023

Information shown on this map is compiled from numerous sources and is not guaranteed to be complete or accurate. Research & Polling, Inc. distributes this map assuming no liability for any error, omissions, or inaccuracies in the information provided regardless of the cause.

RESEARCH  
& POLLING

Proposed Precincts

# Precinct 82 (split from 82)

EXHIBIT  
B5

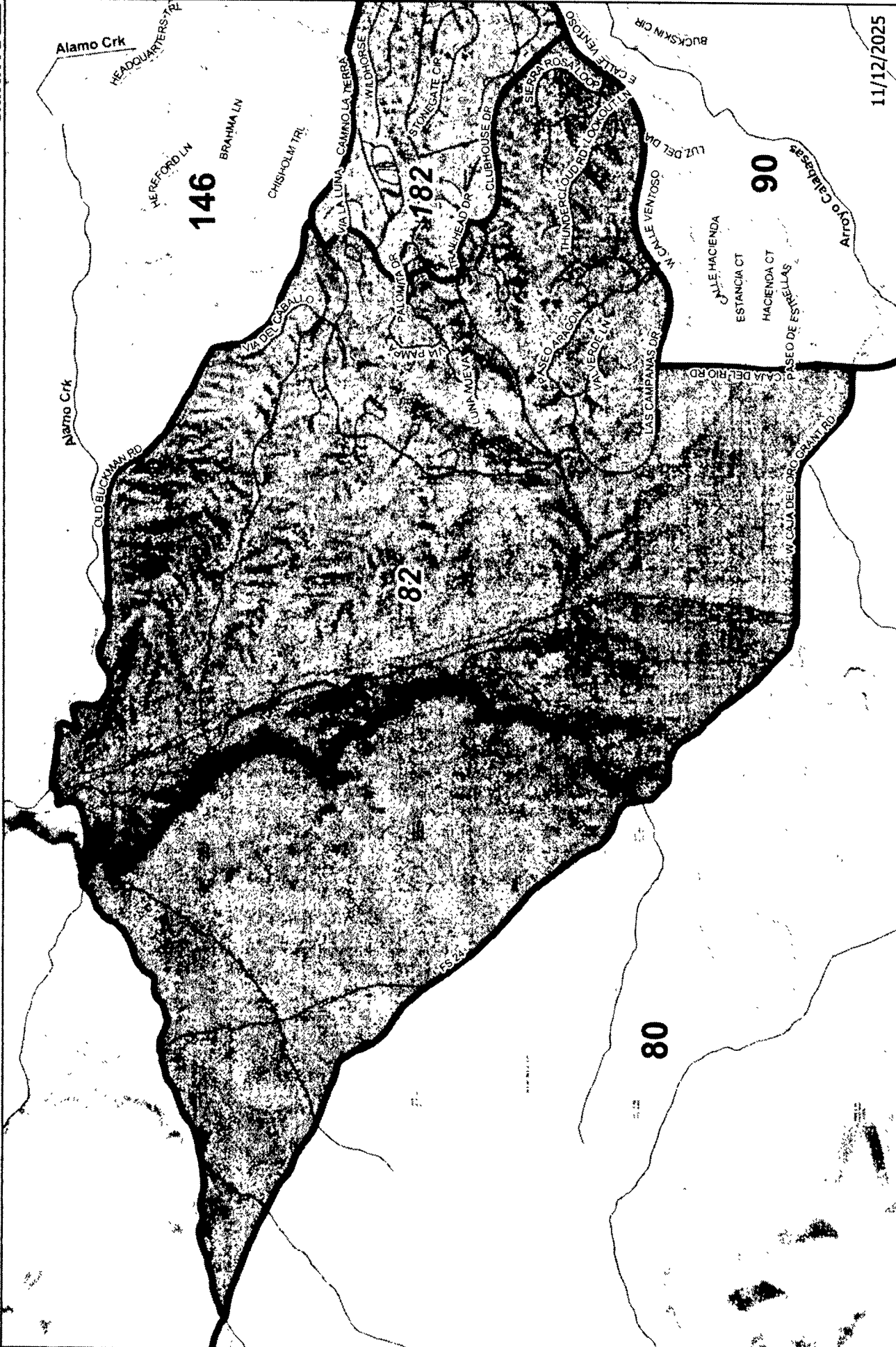

11/12/2025

SFC CLERK RECORDED 12/02/2025

RESEARCH  
POLING

Information shown on this map is compiled from numerous sources and is not guaranteed to be complete or accurate. Research & Poling, Inc. distributes this map assuming no liability for any error, omissions, or inaccuracies in the information provided regardless of the cause.

Proposed Precincts

# Precinct 182 (split from 82)

EXHIBIT  
B6

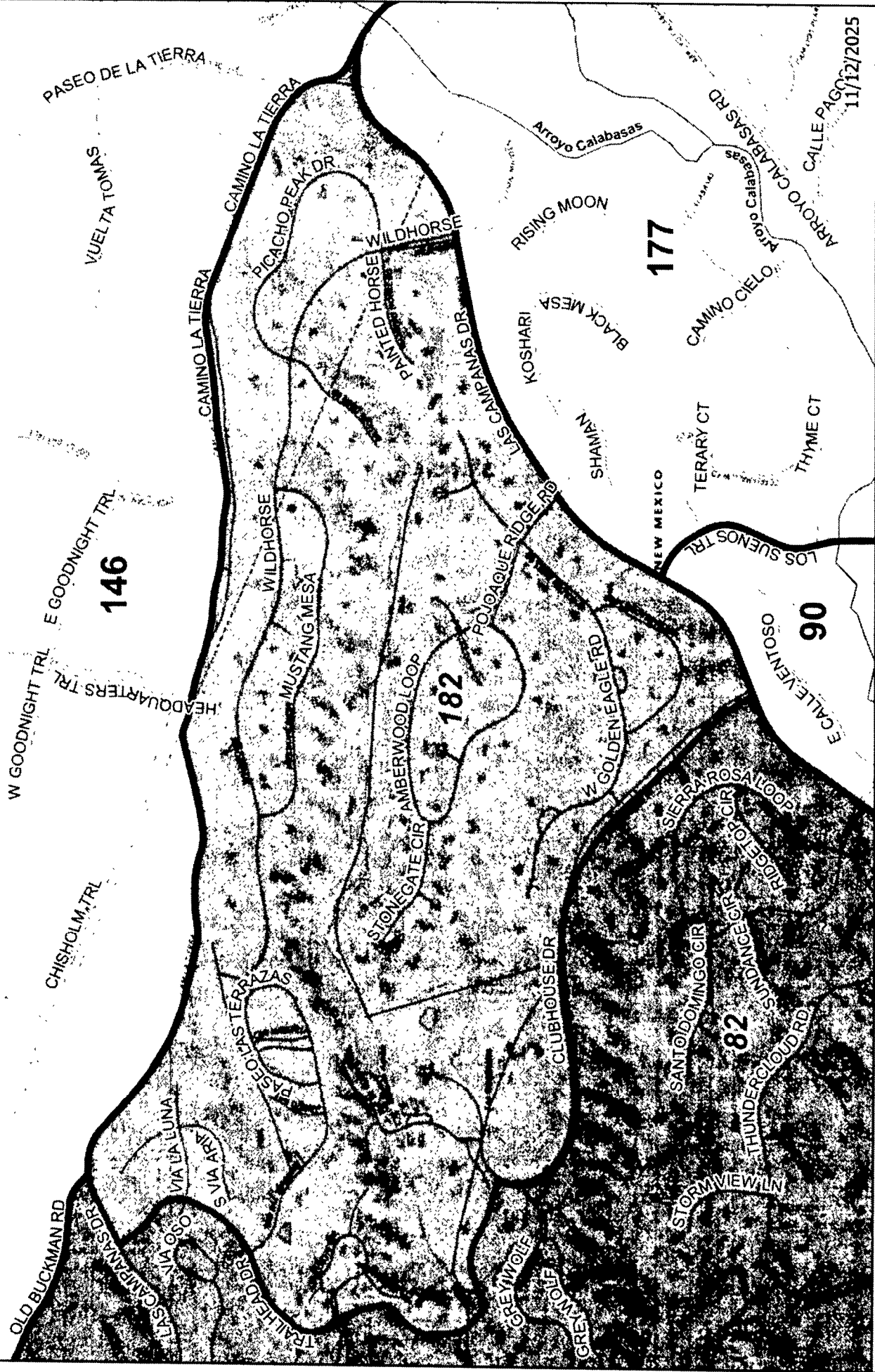

SFC CLERK RECORDED 12/02/2023

Information shown on this map is compiled from numerous sources and is not guaranteed to be complete or accurate. Research & Polling, Inc. distributes this map assuming no liability for any error, omissions, or inaccuracies in the information provided regardless of the cause.

RESEARCH  
& POLLING

Proposed Precincts



11/12/2025

**EXHIBIT  
B7**

**SANTA FE COUNTY**

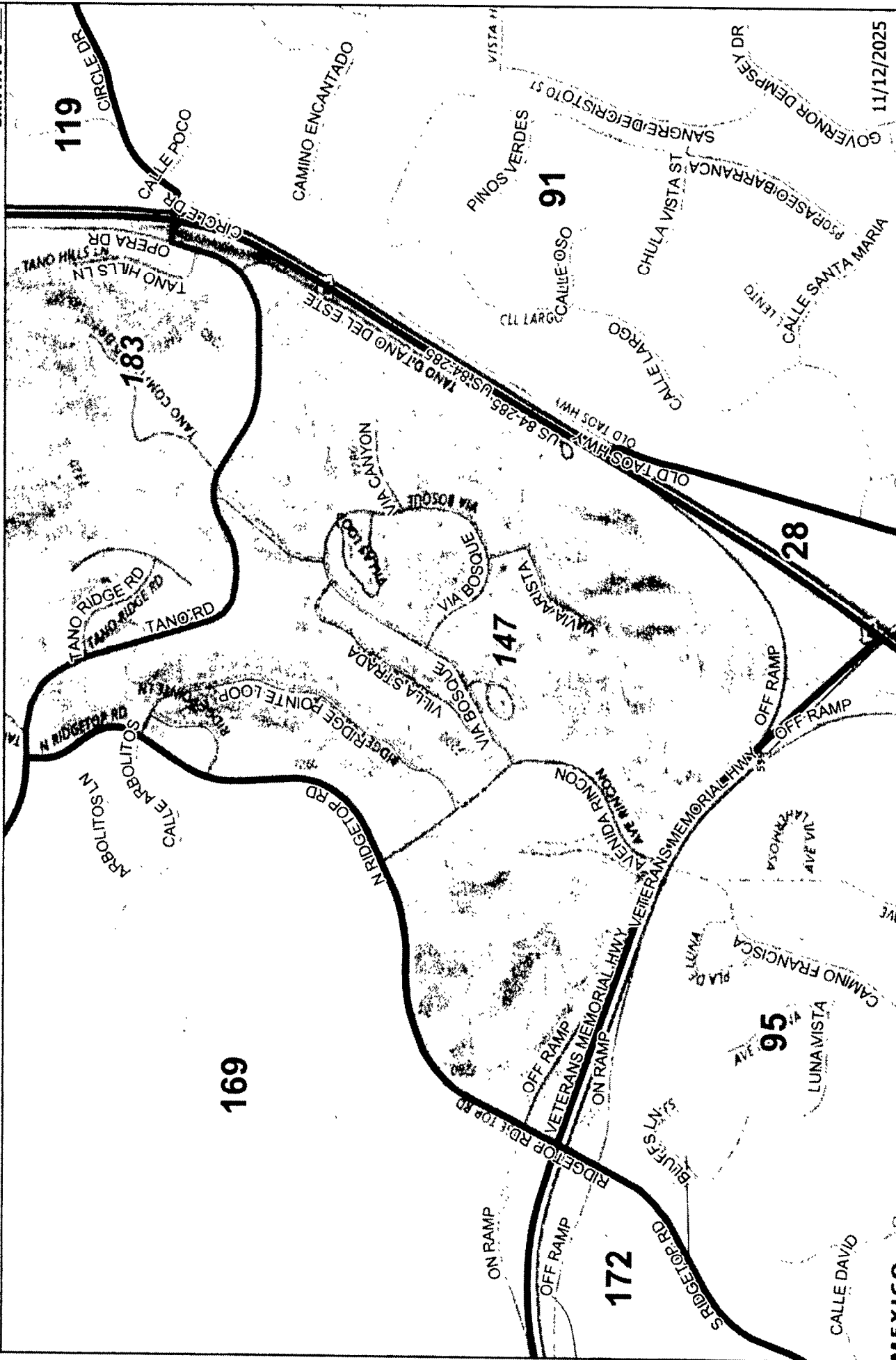

SHC CLERK RECORDED 12/02/2023

Information shown on this map is compiled from numerous sources and is not complete or accurate. Research & Polling, Inc. disclaims this map assuming no liability for any error, omissions, or inaccuracies in the information provided regardless of the cause.

## Proposed Precincts

11/12/2025

**EXHIBIT  
B8**

SANTA FE COUNTY

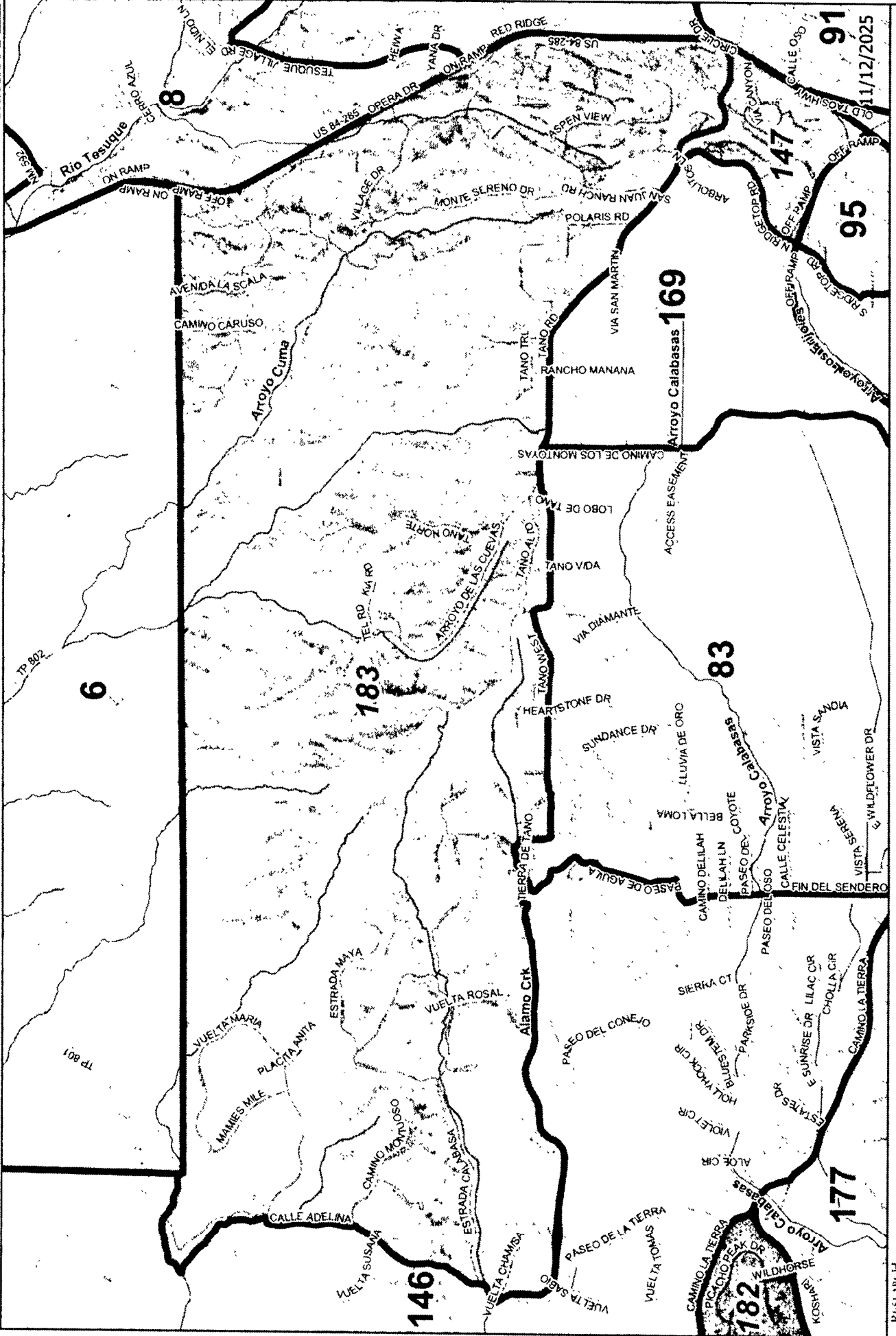

SEC<sup>4130</sup> CLERK RECORDED 12/02/2025

### Proposed Precincts

complete or accurate information shown on this map is compiled from numerous sources and may be subject to change. Research & Polling, Inc. disclaims any liability for any error, omissions, or inaccuracies in the information provided regardless of the cause.

**EXHIBIT**  
**B9**

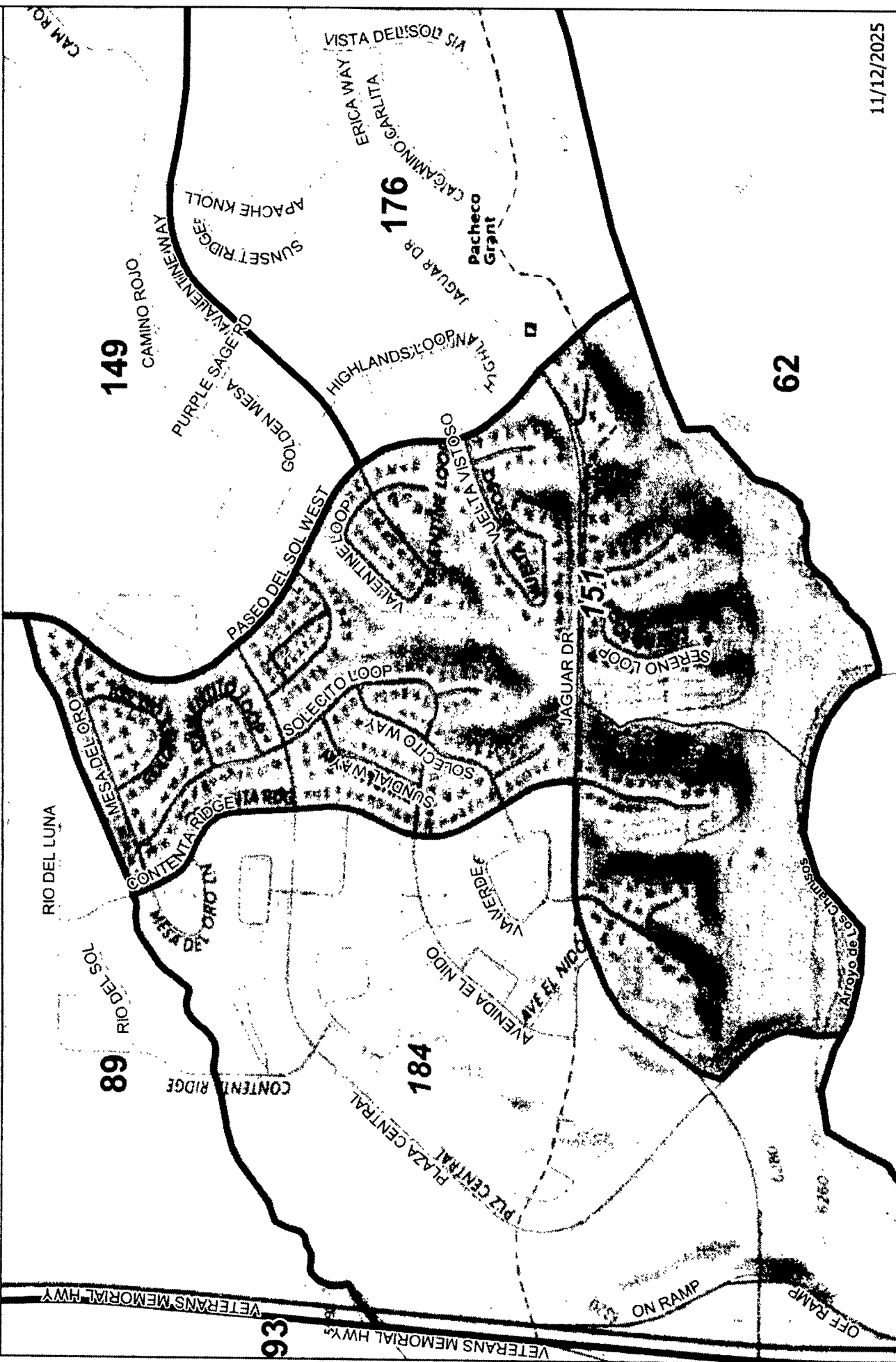

100-400-1000  
SEC CLERK RECORDED 12/02/2025

## RESEARCH FINDINGS

## Proposed Precincts

11/12/2025

# Precinct 184 (split from 151)

EXHIBIT  
B10

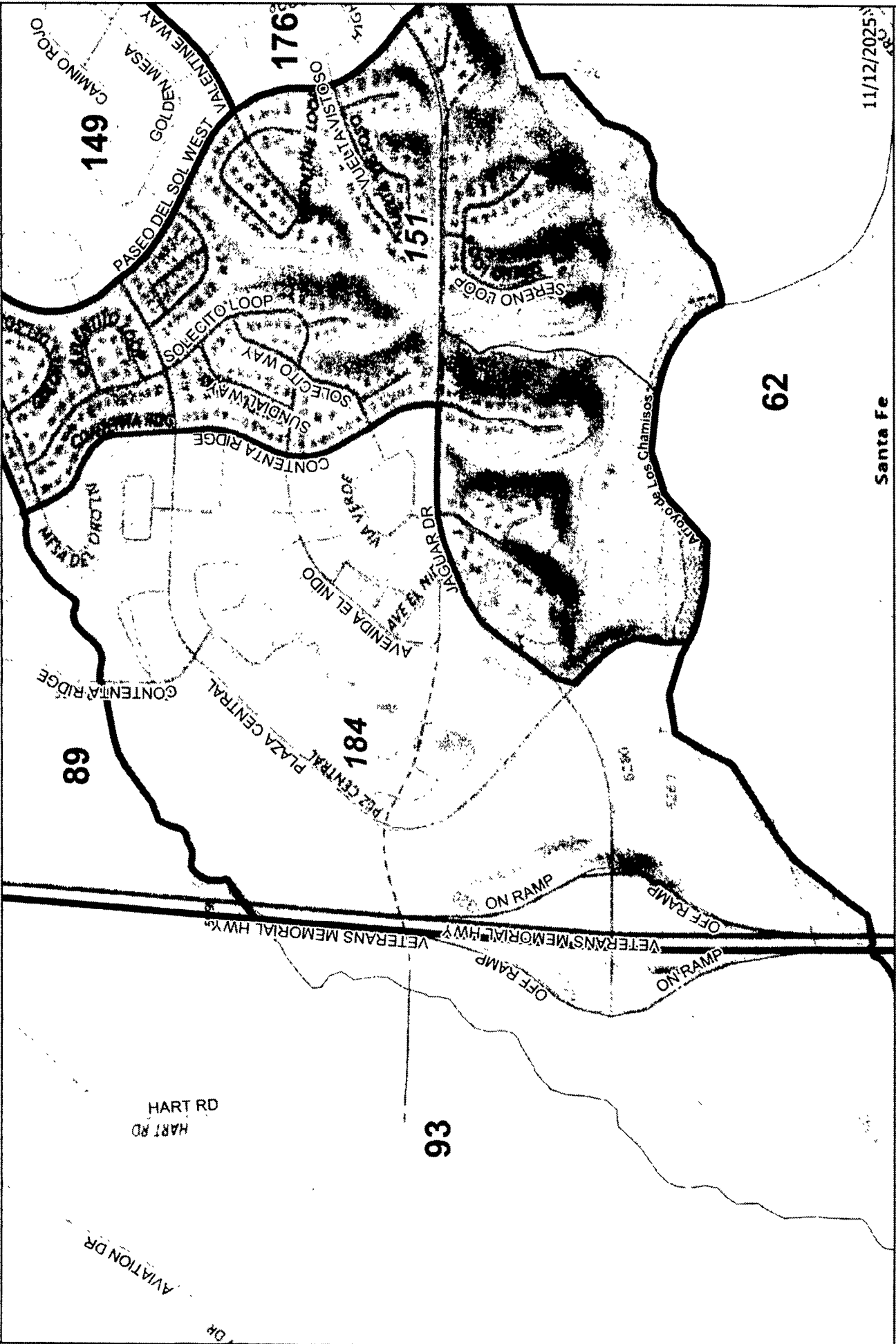

Santa Fe

SFC CLERK RECORDED 12/02/2025

Information shown on this map is compiled from numerous sources and is not intended to be a complete or accurate representation of the actual situation. The distributor of this map assumes no responsibility for any errors, omissions, or inaccuracies in the information provided regardless of the cause.



Proposed Precincts

**EXHIBIT  
B11**

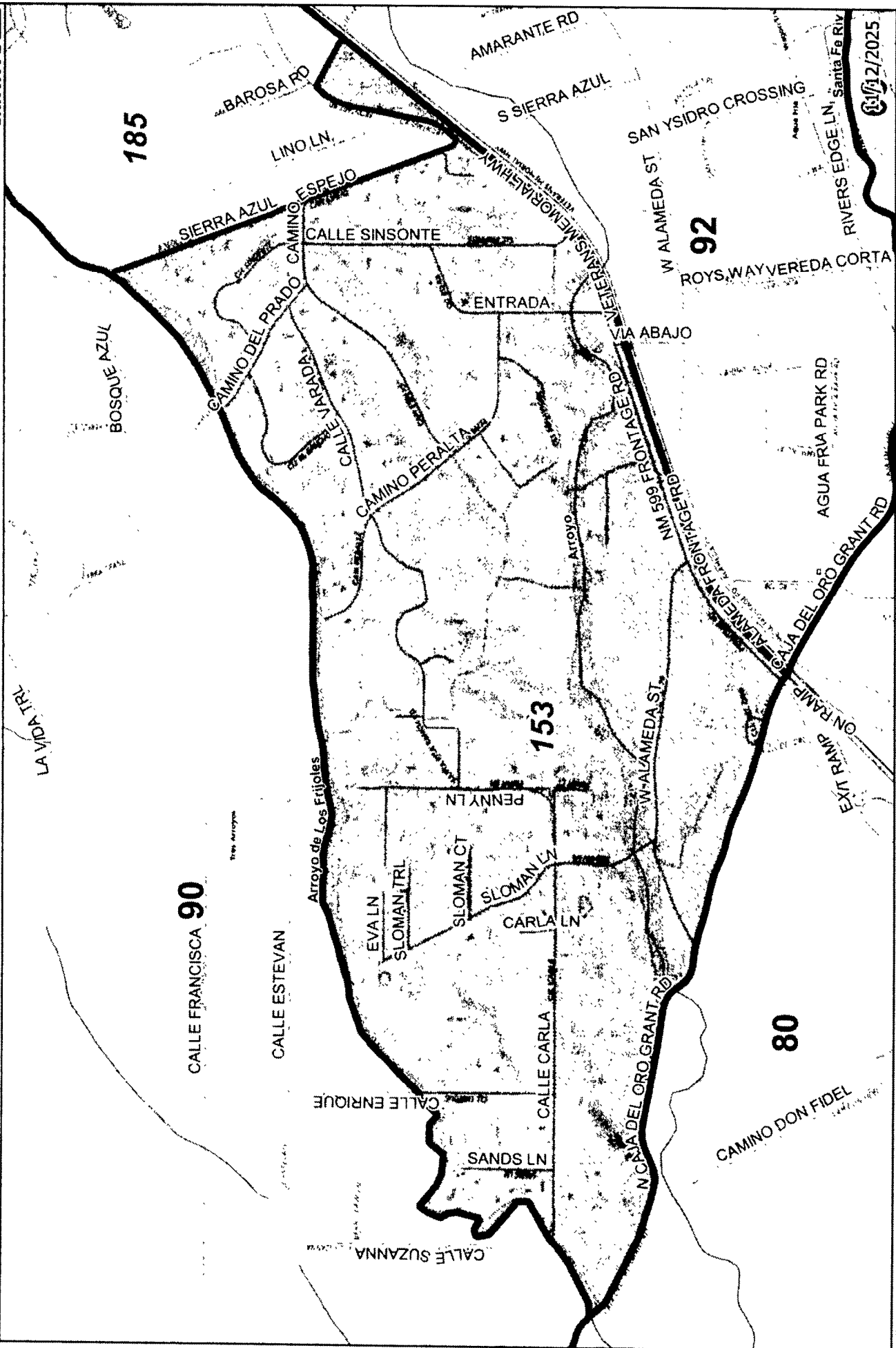

SEC CLERK RECORDED 12/02/2025

## RESULT AND DISCUSSION

## Proposed Precincts

# Precinct 185 (split from 153)

EXHIBIT  
B12

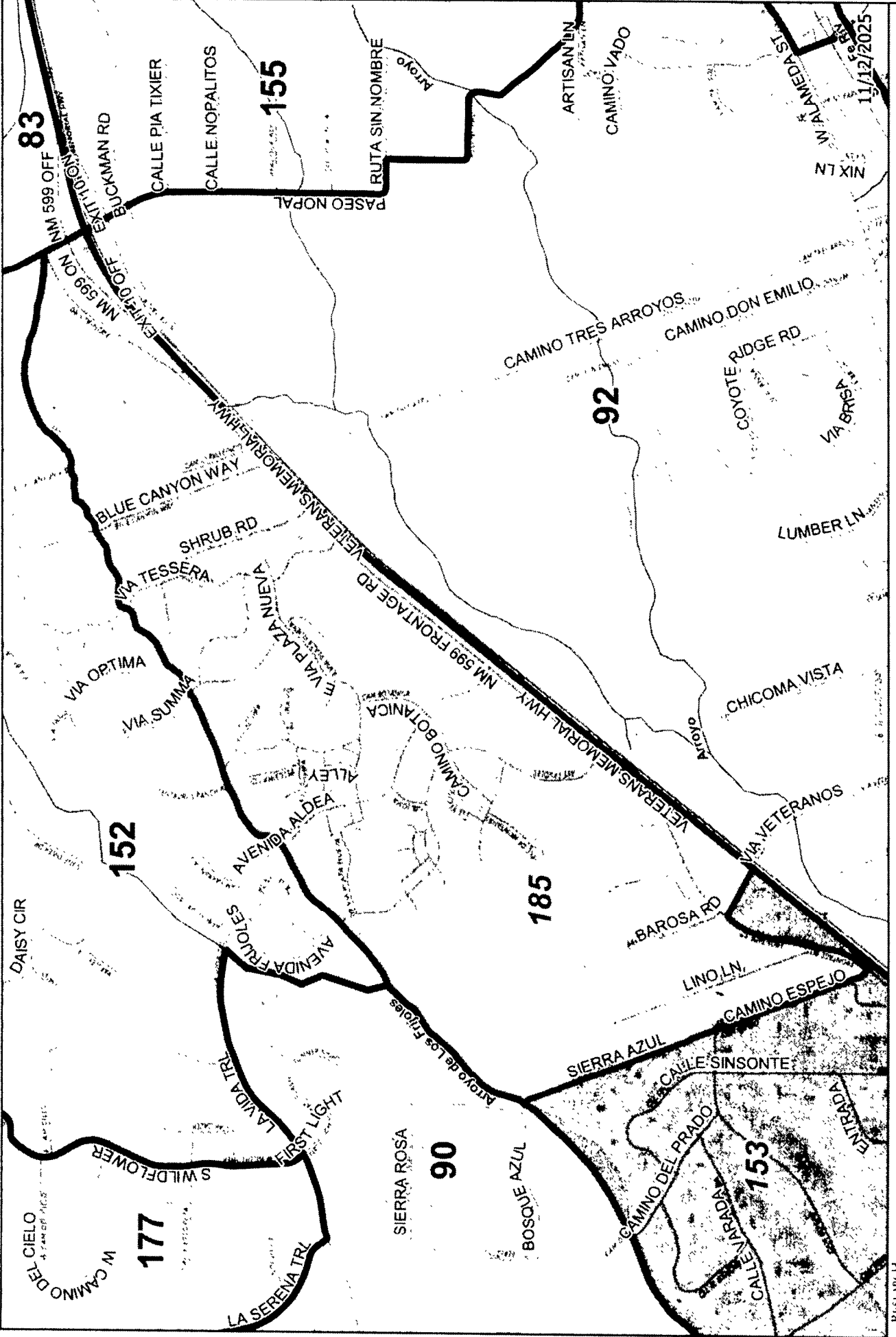

**EXHIBIT****C****Santa Fe County Precinct Descriptions for Precinct Divisions and Adjustments Pursuant to NMSA 1978, Sections 1-3-1 and 1-3-5, to take Effect in 2026**

PRECINCT 56 - Starting at I-25 and State Road 14/Cerrillos Road; thence northeast on I-25 to Richards Avenue; thence north on Richards Avenue to Beckner Road; thence west on Beckner Road to Walking Rain Road; thence north on Walking Rain Road to first intersection with Dancing Ground Road; thence north on Dancing Ground Road to Governor Miles Road; thence west on Governor Miles Road to Cerrillos; thence southwest on Cerrillos Road back to the beginning.

PRECINCT 180 - Starting at Richards Ave and Beckner Road; thence west on Beckner Road to Walking Rain Road; thence north on Walking Rain Road to first intersection with Dancing Ground Road; thence north on Dancing Ground Road to Governor Miles Road; thence east on Governor Miles Road Richards Avenue; thence south on Richards Avenue back to the beginning.

PRECINCT 76 - Beginning at Zia Road and Yucca Street; thence north on Yucca Street to Arroyo de los Chamisos (arroyo); thence west on Arroyo de Los Chamisos (arroyo) to Camino Carlos Rey; thence south on Camino Carlos Rey to Zia Road; thence east on Zia Road back to the beginning.

PRECINCT 181 - Beginning at Rodeo Road and Yucca Street; thence north on Yucca Street to Zia Road; thence west on Zia Road to Camino Carlos Rey; thence south on Camino Carlos Rey to Rodeo Road; thence east on Rodeo Road back to the beginning.

PRECINCT 82 - Beginning at Las Campanas Drive and Clubhouse Drive; thence northwest on Clubhouse Drive to Trailhead Drive; thence north on Trailhead Drive to Las Campanas Drive; thence northeast on Las Campanas Drive to Old Buckman Road; thence northwest on Old Buckman Road to Alamo Creek; thence west on Alamo Creek to Canada Ancha; thence south on Canada Ancha to unnamed arroyo; thence southwest on unnamed arroyo to Forest Service Road 24; thence southeast on Forest Service Road 24 to Caja del Oro Grant Road; thence east on Caja del Oro Grant Road to Caja del Rio Road; thence north on Caja del Oro Road to Las Campanas Drive; thence northeast on Las Campanas Drive back to the beginning.

PRECINCT 182 - Beginning at Las Campanas Drive and Clubhouse Drive; thence northwest on Clubhouse Drive to Trailhead Drive; thence north on Trailhead Drive to Las Campanas Drive; thence northeast on Las Campanas Drive to Camino la Tierra; thence east on Camino la Tierra to Las Campanas Drive; thence southwest on Las Campanas Drive back to the beginning.

PRECINCT 147 – Beginning at NM Highway 599 and Ridgetop Road; thence northeast on Ridgetop Road to Tano Road; thence southeast on Tano Road to Opera Drive; thence north on Opera Drive to Paz Bridge; thence east on Paz Bridge to US Highway 84/285; hence south on US Highway 84/285 to NM Highway 599; thence northwest on NM Highway 599 back to the beginning.

PRECINCT 183 – Beginning at US Highway 84/285 and Paz Bridge; thence north on US Highway 84/285 to southern Tesuque Pueblo boundary; thence west on Tesuque Pueblo boundary to unnamed arroyo; thence west on unnamed arroyo to unnamed arroyo; thence south on unnamed arroyo to Vuelta Maria; thence west on Vuelta Maria to Calle Adelina; thence south on Calle Adelina to Paseo de la Tierra; thence south on Paseo de la Tierra to unnamed arroyo; then southwest on unnamed arroyo to unnamed arroyo; thence east on unnamed arroyo to Estrellas de Tano; hence south on Estrellas de Tano to Tano West; thence east on Tano West to Tano Road; thence southeast on Tano Road to Opera Drive; thence north on Opera Drive to Paz Bridge; thence east on Paz Bridge back to the beginning.

SFC CLERK RECORDED 12/02/2025

PRECINCT 151 – Beginning at the dirt road extension of Paseo del Sol West and unnamed gully; thence north on dirt road extension of Paseo del Sol West to Paseo del Sol West; thence north on Paseo del Sol West to gully north of Mesa del Oro; thence southwest on gully to Contenta Ridge; thence south on Contenta Ridge to Jaguar Drive; then southwest on Jaguar Drive to Plaza Central; thence south on Plaza Central to drainage down to Arroyo de las Chamisas; thence south on drainage down to Arroyo de las Chamisas to Arroyo de las Chamisas; thence east on Arroyo de las Chamisas to unnamed gully; thence northeast on unnamed gully back to the beginning.

PRECINCT 184 – Beginning at NM Highway 599 and Arroyo de las Chamisas; thence north on NM Highway 599 to gully; thence northeast on gully to Contenta Ridge; thence south on Contenta Ridge to Jaguar Drive; then southwest on Jaguar Drive to Plaza Central; thence south on Plaza Central to drainage down to Arroyo de las Chamisas; thence south on drainage down to Arroyo de las Chamisas to Arroyo de las Chamisas; thence west on Arroyo de las Chamisas back to the beginning.

PRECINCT 153 – Beginning at NM Highway 599 and Caja del Oro Grant Road; thence northwest on Caja del Oro Grant Road to Arroyo de los Frijoles; thence northeast on Arroyo de los Frijoles to Sierra Azul; then south on Sierra Azul to NM Highway 599 Frontage Road; thence northeast on NM Highway 599 Frontage Road to Via Veteranos; thence southeast on Via Veteranos to NM Highway 599; then southwest on NM Highway 599 back to the beginning.

PRECINCT 185 – Beginning at Sierra Azul and Arroyo de los Frijoles; thence northeast on Arroyo de los Frijoles to unnamed arroyo; then northeast on unnamed arroyo to Camino la Tierra; thence south on Camino la Tierra to NM Highway 599; then southwest on NM Highway 599 to Via Veteranos; thence northwest on Via Veteranos to NM Highway 599 Frontage Road; thence southwest on NM Highway 599 Frontage Rd to Sierra Azul; thence north on Sierra Azul back to the beginning.

SFC CLERK RECORDED 12/02/2025