

Henry P. Roybal
Commissioner, District 1

Anna Hansen
Commissioner, District 2

Rudy N. Garcia
Commissioner, District 3

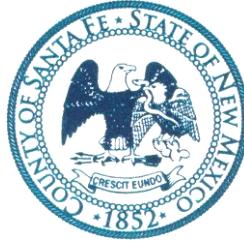

Anna T. Hamilton
Commissioner, District 4

Ed Moreno
Commissioner, District 5

Katherine Miller
County Manager

January 15, 2020

ADDENDUM #1
IFB# 2020-0098-PW/KE
LA PUEBLA FIRE STATION

Dear Proponents,

This addendum is issued to reflect the following immediately. It shall be the responsibility of interested Offerors to adhere to any changes or revisions to the IFB as identified in this Addendum No. 1. This documentation shall become permanent and made part of the departmental files.

ATTACHMENT 1: PRE-BID SIGN IN SHEET (3)
2: SKA-101.01

1. Is the Web address on the Advertisement correct?

ANSWER: Yes the web address will take you directly to our web site where all documents can be found. https://www.santafecountynm.gov/asd/current_bid_solicitations

2. On page 00 3000 – 5.12 Bid Form: C. is requesting a Corporate Seal, is BID PROPOSAL 00 4000-1 requesting the “Signature-Title” to be the attested by the Secretary?

ANSWER: The Bid Proposal is to have your Corporate Seal if incorporated and signed by an approved signer to the Corporation.

3. There have been several questions concerning substitution of material prior to Bids being received.

ANSWER: Please refer to the IFB Section 00 3000 – Instructions for Bidders, page 4 Number 10. Substitutions: “The materials, products, and equipment described in the Bid Documents establish a standard of required function, dimension, appearance and quality to be met by any proposed substitution. **No substitution will be considered prior to receipt of bids.**”

4. The specs call for an AISC shop and we do not see where you allow for an equal or better? Also, this is a relatively small project with very little steel, why is a spec for an AISC shop included. If we fabricate to AISC standards is this acceptable?

ANSWER: Regarding section 05 12 00 Structural Steel, AISC requirements, equal or better is acceptable. Fabrication to AISC standards is acceptable in lieu of being an AISC-Certified Plant.

5. What are the dimensions for Exterior Signage? The spec sheet states that the number “31” will be 6” tall. This appears to be different when looking at the Exterior Elevations drawing on A-201, if the scaling is correct that would make the numbers 2’ tall. Also, has a depth been requested for the numbers?

ANSWER: Exterior signage is to be 24“ tall and 1“ deep

6. There are specifications for seeding and irrigation, but there are no landscape plans, Are there plan sheets for landscaping? What is required for landscaping?

ANSWER: No separate sheets for Landscaping. Sections 32 84 23 & 32 92 13 are intended for use revegetating the disturbed areas, see C-103 KN19 for locations.

7. On sheet C-103 Notes 11 & 12 it says to see Sheet S 502 but there is no Sheet S 502, Explain?

ANSWER: See 11/S-301 & C-502 for retaining wall detailing

8. Rooms 105, 106 and 112 ask for tile flooring, can you explain what type of flooring this is?

ANSWER: Tile and Ceramic Tile noted in the finish schedule on A-601 schedule both refer to the same material. Refer to specifications 09 30 00 Tiling; Section 2.02 Materials; line item D. schedule tiles; line item 1; Tile 1.

9. At the patio in the rear of the building between the retaining wall and the building – is all of it concrete or just parts of it concrete? If just part concrete, what parts?

ANSWER: Refer to SKA-101.01 for paving and ground cover clarifications. (Attached)

10. The Geotechnical Survey denotes that the manmade fill goes 13’ below grade at the 2 core sites and requires this manmade fill be removed for replacement with engineered fill. Is this removal expected to be done at 13’ below grade consistently as we move down the slope, or 13’ down at core sample locations and horizontal away from the building?

ANSWER: Any manmade fill underlying the proposed structure shall be removed and replaced with engineered fill as stated in the geotechnical report. The 2007 report included in this bid set was produced prior to the last building addition. The dirt in question has been moved and/or removed. Although, similarly in this project the back-fill dirt piled up against the current building, approximately 13’ deep at its peak, is not to be used as structural fill on

this project. It is anticipated that grading removals for the building footprint and foundations will eliminate the material in question from the structural areas to the extents noted in the report.

11. Page A-103 there is soffits shown surrounding the kitchen area with details 8 and 10/A-531 identified. These details appear to show cold rolled steel studs used for the framing details and indicate to see the structural schedule for more information on the box headed shown in detail 8/A-531. Can you advise where within the structural portion of the drawings the information referring to a box header or cold rolled steel can be found?

ANSWER: Headers and soffit framing are to be wood not steel. Utilize industry standards for non-load bearing framing.

12. Will the surveyor need to include pricing to field verify quantities?

ANSWER: Site total cut is calculated at 2656 CY. Stockpile on site. Field verification will not be required for the lump sum contract. However, if the amount goes beyond that quantity, then back up documentation would be needed for additional payment requests

13. What is the dollar value of this project?

ANSWER: MACC 1,341,000.00

14. When is projected start date?

ANSWER: Construction anticipated to begin March 2020

15. What access will there be to the old building and where is parking allowed?

ANSWER: Facility will remain in use throughout project. There is no contractor access for use of existing kitchen or restroom facilities. Access for construction purposes is expected. Areas may be cordoned off for contractor's use temporarily as needed. Contractors may utilize power and water at no charge. Reasonable & coordinated utility outages during construction are anticipated. Parking for contractors is available on the property, north and west of the station.

Please add this Addendum #1 to the original bid documents and refer to bid documents, hereto as such. This and all subsequent addenda will become part of any resulting contract documents and have effects as if original issued. All other unaffected sections will have their original interpretation and remain in full force and effect.

Bidders are reminded that any questions or need for clarification must be addressed to Karen K. Emery, Senior Procurement Specialist at kkemery@santafecountynm.gov.

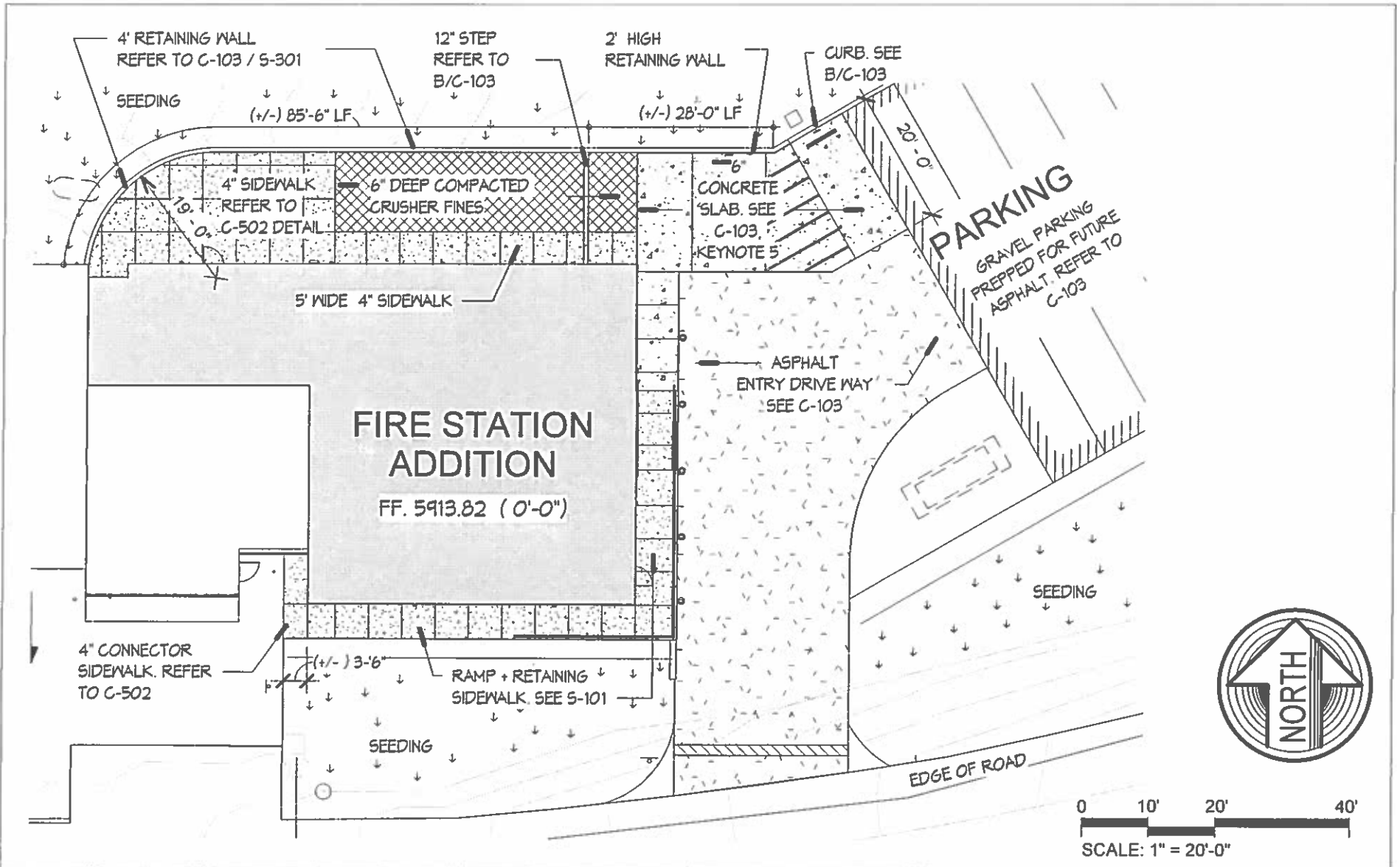

MOLZENCORBIN

LA PUEBLA FIRE STATION ADDITION
LA PUEBLA, NEW MEXICO
Addendum #1
SKA-101.01



SANTA FE COUNTY

**SIGN IN SHEET FOR PRE-BID MEETING
SITE LOCATION**

IFB# 2020-0098-FD/KE

**CONSTRUCTION OF ADDITION
TO THE LA PUEBLA FIRE STATION**

January 8, 2020

10:00 AM

(Please Print Clearly)

NAME	COMPANY	TELEPHONE	E-MAIL ADDRESS
Randall	AIC-General Contractors	239-1844	Randall@AIC-GC.com
Noelle Elliott	AIC-General Contractors	406-0856 675-8515	Noelle@AIC-GC.com
Ron Stendiferd	Anchor Built	342-2542	rstendiferd@abi-mechanical.com
Cameron Potter	Contreras Construction Corp	505 503-0680	CPotter@ContrerasConstructionCorp.com
FRANK ROBINSO	CONNEN INDUSTRIES	804 395-6648	frank@CONNENINDUSTRIESTX.COM
Marsha Whiteley	Pace of NM Elec	505- 918-3248	Mwhiteley@southwest-gc.com
Allan Duchin	Precision Service	505-259-4709	PSE 88208@Comcast.net
EVERETT DIX	FIRST MESA CONST.	505-843-8990	everett@firstmesa.net
Melvin Cordova	MCElectric Inc	505-470-2294	mcelectricinc@live.com
Bob Rogers	Steven Construction Inc	505-984-7550	ANBEIRAIR@STEVENCONSTRUCTION.COM



SANTA FE COUNTY
SIGN IN SHEET FOR PRE-BID MEETING
SITE LOCATION

IFB# 2020-0098-FD/KE

CONSTRUCTION OF ADDITION
TO THE LA PUEBLA FIRE STATION

January 8, 2020

10:00 AM

(Please Print Clearly)

NAME	COMPANY	TELEPHONE	E-MAIL ADDRESS
BILL HENDERSON	MICK RICH CONTRACTORS	505-823-9782	BILL@MICKRICHCONTRACTORS.COM
Rob Winn	Blue Sky Builders, Inc.	(505) 470-0021	rob@blueskybuilders-inc.com
GABE DIAVEDRA	A-Com Technologies	505-344-1370	GABES@A-COMTECH.COM
Daniel Feliciano	T.A. Cole & Sons	505-328-0518	BRANDONW@TACOLESONS.COM
David Ramos	RVC INC	505-753-8374	David@RVCINC.NET
RICK CARTWRIGHT	ACE ASPHALT	505-633-6058	cartwrightr@ACEASPHALT.COM
Nicole Manns	Cloverleaf Solutions	505-604-8417	nmanns@cloversolutions.us
Dale F. Salazar	Leroy's Excavating	(505) 753-3148	dalesalazar@windstream.net
Robert Sanchez	Land Construction	505-927-2027	robert@landconstruction.com
Lisa Lopez	Daniel Cordova Cobros de Santa Fe	505 920 4516	cdsfpl997@yahoo.com



SANTA FE COUNTY

**SIGN IN SHEET FOR PRE-BID MEETING
SITE LOCATION**

IFB# 2020-0098-FD/KE

**CONSTRUCTION OF ADDITION
TO THE LA PUEBLA FIRE STATION**

January 8, 2020

10:00 AM

(Please Print Clearly)

NAME	COMPANY	TELEPHONE	E-MAIL ADDRESS
Quintin Wright	Longhorn Construction Services	505-958-1360	lcsinc@comcast.net
Chris Pacheco	Pluma	505.745.0755	Chris@plumax.com
Jeremy Alford	Molzen Corbin	505-242-5700	jalford@molzenandco.com
Jeff Carroll	SFCFD	505 680-9818	jcarroll@sfccountynm.gov