

1/11/2024 10:15:17 AM

C:\Users\jparagard\Documents\2303 Abdon Lopez Senior Center_CENTRAL_parragard\105.rvt

GENERAL NOTES

- A. COORDINATE WITH CIVIL, STRUCTURAL, MECHANICAL, ELECTRICAL & PLUMBING.
- B. SUBMIT SAMPLES OF ALL GRAVEL AND GROUNDCOVER FOR ARCHITECTS TO REVIEW.
- C. NEW PLANTING AND IRRIGATION PLAN TO BE COORDINATED WITH SANTA FE COUNTY REQUIREMENTS.
- D. COORDINATE GRADING AND DRAINAGE WITH CIVIL ENGINEER.
- E. REFER TO AS102 FOR PARKING LOT DIMENSIONS.
- F. NEW SITE LIGHTING TO BE COORDINATED WITH SANTA FE COUNTY REQUIREMENTS.
- G. ALL NEW SITE PAVING, CURB AND GUTTER TO COMPLY WITH NMDOT STANDARDS.

KEYED NOTES

- 1 EXISTING CONCRETE PAVING / SIDEWALK TO REMAIN.
- 2 EXISTING ASPHALT PAVING TO REMAIN
- 3 EXISTING BOYS AND GIRLS CLUB. NOT IN SCOPE OF WORK
- 4 EXISTING HUD HOUSING TO REMAIN
- 5 EXISTING LANDSCAPE TO REMAIN
- 6 EXISTING TREES / PLANTING TO REMAIN
- 7 EXISTING FENCE TO REMAIN
- 8 EXISTING PLAYGROUND EQUIPMENT TO REMAIN. NOT IN SCOPE OF WORK
- 9 NEW SENIOR CENTER BUILDING REFER TO A-101
- 10 NEW TREES, PLANTING AND IRRIGATION, TYPICAL
- 11 NEW CONCRETE PAVING
- 12 NEW CONCRETE SIDEWALK.
- 13 PAINTED CROSSWALK
- 14 NEW RETAINING WALL. SEE STRUCTURAL
- 15 CAST-IN-PLACE CONCRETE BENCH.
- 16 LANDSCAPING AREA
- 17 NEW SECTION OF FENCE. TIE INTO EXISTING FENCE WHERE POSSIBLE.
- 18 LINE OF PORTAL ABOVE. REFER TO A-121
- 19 PARKING STRIP, TYPICAL.
- 20 NEW ASPHALT PAVING, TYPICAL
- 21 NEW CURB AND GUTTER.
- 22 "ACEQUIA" / DRAINAGE SWALE
- 23 NEW MODULAR BLOCK RETAINING WALL. DESIGN TO BE ENGINEERED AND COORDINATED WITH BLOCK MANUFACTURER. COORDINATE WITH CIVIL THE EXTENTS OF RETAINING WALLS.
- 24 TRASH ENCLOSURE
- 25 BICYCLE RACK
- 26 FUTURE COVERED PARKING WITH SOLAR ARRAY
- 27 FUTURE EV. CONTRACTOR TO PROVIDE INFRASTRUCTURE
- 28 ADA PARKING SIGN
- 29 EXISTING ELECTRICAL TRANSFORMER AND UTILITY BOX TO REMAIN.
- 30 POLE LIGHTING
- 31 SANITARY CLEANOUT
- 32 GREASE INTERCEPTOR
- 34 BELOW GRADE CISTERN. SEE CIVIL.

LEGEND

- EXISTING CONSTRUCTION / SITE TO REMAIN
- PROPERTY LINE
- FENCE TO REMAIN
- NEW FENCE
- EASEMENT
- BUILDING FOOTPRINT
- NEW ASPHALT PAVING
- GRAVEL / LANDSCAPE 01
- GRAVEL / LANDSCAPE 02
- ANGULAR COBBLE / ACEQUIA LANDSCAPE
- EXISTING LANDSCAPE TO REMAIN
- NEW CONCRETE / SIDEWALK
- EXISTING CONCRETE / SIDEWALK TO REMAIN
- ADA SIGN REFER TO AS105



2101 Mountain Road NW Suite B | Albuquerque NM 87104
505-843-9639 | www.studioswarch.com

© 2023 Studio Southwest Architects, Inc. Duplication or reproduction by any means without the express written consent of Studio Southwest Architects, Inc. is a violation of federal and international law. The information contained in this document is the intellectual property of Studio Southwest Architects, Inc. and all rights thereto are reserved.

CONSULTANTS

Architect	Engineer

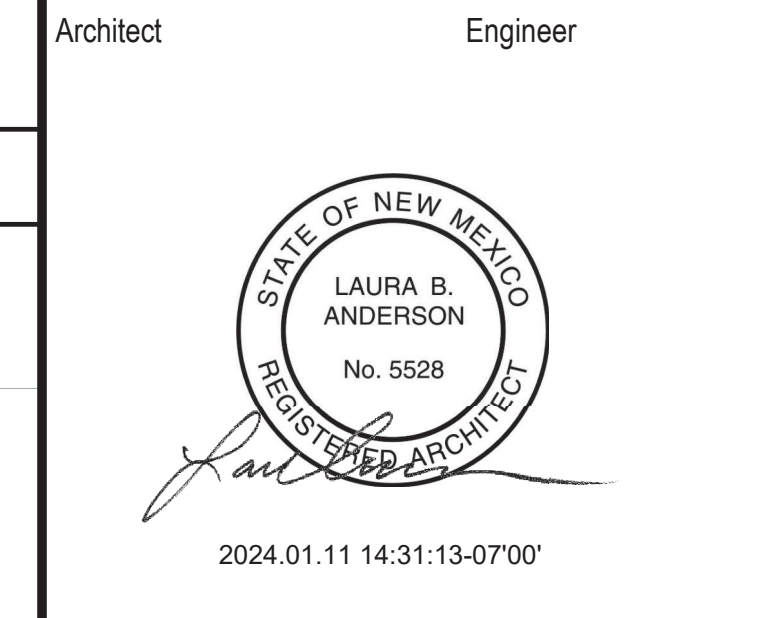

SANTA FE COUNTY - ABEDON LOPEZ SENIOR CENTER

155A CAMINO DE QUINTANA
SANTA CRUZ, NM 87567

No	Date	Description
Revision Schedule		
ISSUE:	100% CONSTRUCTION DOCUMENTS	
PROJECT NUMBER:	2303	
FILE:	SFC Abdon Lopez Senior Center	
DRAWN BY:	PS	
CHECKED BY:	LA	
DATE:	SEPT. 20, 2023	

SHEET TITLE ARCHITECTURAL SITE PLAN

AS101

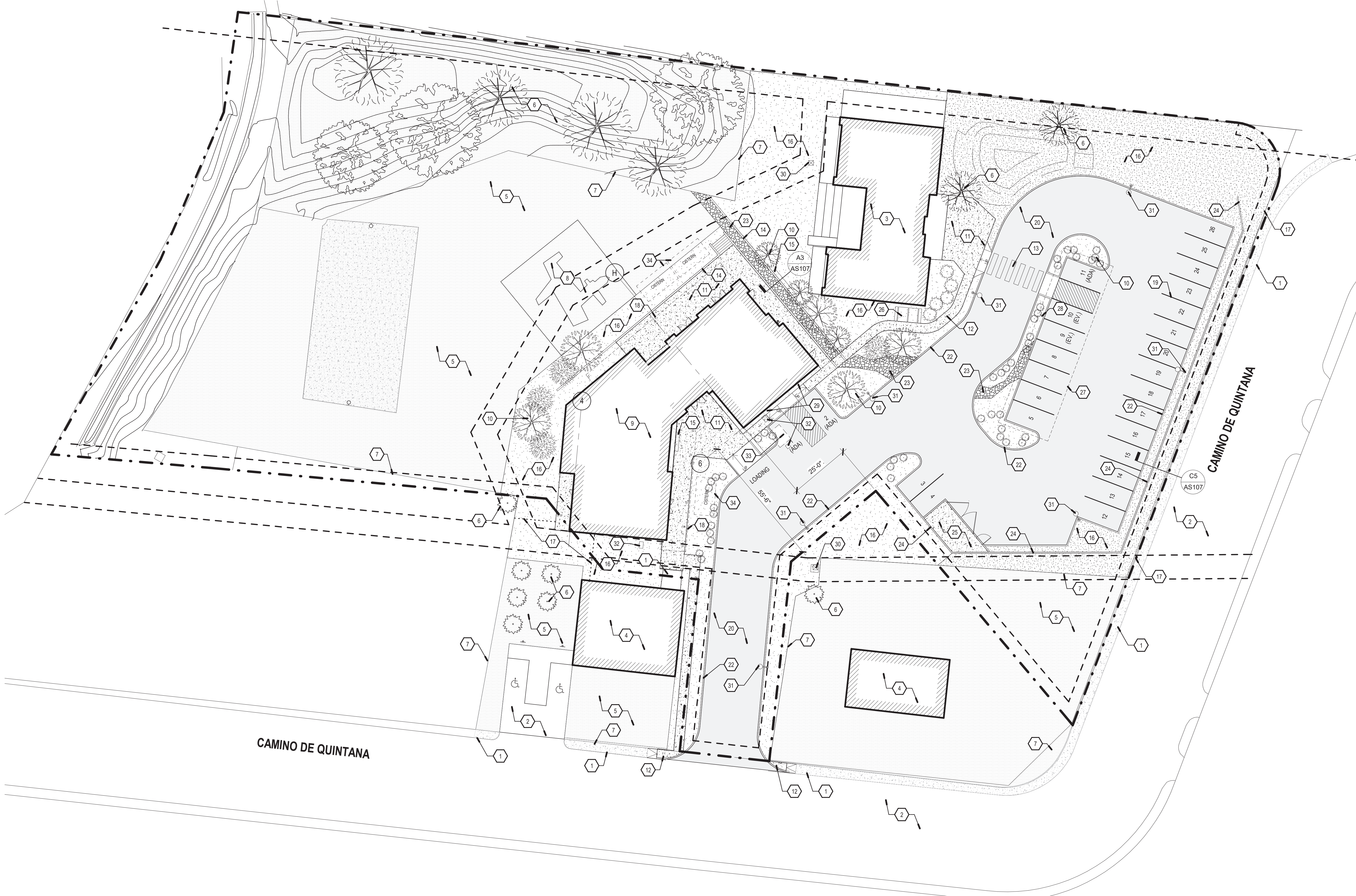

A1 ARCHITECTURAL SITE PLAN

1" = 20'-0"

