

Henry Roybal
Commissioner, District 1

Anna Hansen
Commissioner, District 2

Rudy N. Garcia
Commissioner, District 3



Anna T. Hamilton
Commissioner, District 4

Hank Hughes
Commissioner, District 5

Katherine Miller
County Manager

February 15, 2022

SANTA FE COUNTY
IFB 2022-0070-PW/APS
RE-BID CONSTRUCTION SERVICES MADRID FIRE STATION EXPANSION
ADDENDUM NO. 1

Dear Proponents,

This addendum is issued to reflect the following immediately. It shall be the responsibility of interested Bidders to adhere to any changes or revisions to the IFB as identified in this Addendum No. 1. This documentation shall become permanent and made part of the departmental files.

**THE DEADLINE FOR ALL BIDS HAS BEEN EXTENDED TO:
THURSDAY, MARCH 3, 2022 AT 2:00PM**

Attachment A: Pre-Bid Sign-In Sheet

Attachment B: Floor Plan

Clarification: Full size plans have been posted on the Santa Fe County website.

Question 1: Do you have a design firm assigned to this project?

Answer 1: NCA Architects

Question 2: What is the estimated construction cost?

Answer 2: The MACC is \$545,990.00

Question 3: It is not clear on the plan set what is existing and what is new construction?

Answer 3: Please see attachment B

Question 4: What is the square footage of the new construction?

Answer 4: Please see sheet G201 in IFB. The new addition is 584 sq. ft. and additive alternative 1 is 153 sq. ft. The total square footage is 737 sq. ft.

Question 5: I was referred to this job by Carl Hansen the Madrid Fire Chief, will this be considered conflict of interest?

Answer 5: No, however there must be no further contact with any other County employees other than Amanda Patterson-Sanchez, Procurement Specialist Senior, or the Bidder may be disqualified.

Question 6: page 19 – You are requesting a *United State Treasury Number* – is this our Federal ID number?

Answer 6: Yes

Question 7: You are showing a wage decision dated 2021 in the bid packet but I don't see an actual decision number. Do you have a wage decision number that was given in 2021 because the 2022 wage decision is much higher?

Answer 7: A new wage decision is currently being processed for 2022 and will be made available in Addendum No. 2 which will be posted on Wednesday, February 23, 2022

Please add this Addendum No. 1 to the original proposal documents and refer to proposal documents, hereto as such. This and all subsequent addenda will become part of any resulting contract documents and have effects as if original issued. All other unaffected sections will have their original interpretation and remain in full force and effect. Responders are reminded that any questions or need for clarification must be addressed to Amanda Patterson-Sanchez, Procurement Specialist Senior at apatterson-sanchez@santafecountynm.gov.

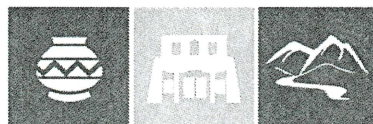

SANTA FE COUNTY

MANDATORY PRE-BID MEETING







IFB 2022-0135-FIN/APS RE-BID CONSTRUCTION SERVICES MADRID FIRE STATION

FEBRUARY 9, 2022 AT 2:00PM

NAME	COMPANY	TELEPHONE	E-MAIL ADDRESS
Amanda Patterson Sanchez	SFC Purchasing	(505) 545-9675	apatterson-sanchez@santafe County.nm.gov
Carl Hansen	Madrid VFD	505 470-0770	
RICHARD FREDERIKS	FREDERIKS CONSTR	505-600-9888	richard@frederiksonconstruct.com
MATT BRYANT	PLUMA LLC	(505) 715-7335	MATT@PLUMYS.COM
Kevin Rodriguez	Pluma LLC	(505) 217-8340	Kevin@plumys.com
Joshua Hernandez	DLF Construction	(505) 361-8371	Jhernandez@dlfci.com
Jeff Romero	STOVEN	505-884-7550	angela.blair@stovenconstruction.com
PJ Montano	SFC	505 992 3037	pmontano@santafecounty.nm.gov
Michael Wright	Michael Austin Wright LLC	505 577 4907	mwa@madud@aol.com
Arrie Olson	SFC	505 992 9960	colin@santafecounty.nm.gov
Miguel Romero	SFC		Mromero@santafecounty.nm.gov

LEGEND

- EXISTING TO REMAIN
- EXISTING TO BE REMODELED
- NEW ADDITION
- NEW ADDITION - ADDITIVE ALTERNATE #1
- NEW ADDITION - ADDITIVE ALTERNATE #2

-  EXISTING DOOR AND FRAME TO REMAIN
-  EXISTING WALL TO REMAIN
-  NEW EXTERIOR WALL
-  NEW INTERIOR WALL
-  NEW INFILL WALL TO MATCH EXISTING
-  NEW WINDOW
-  NEW DOOR AND FRAME

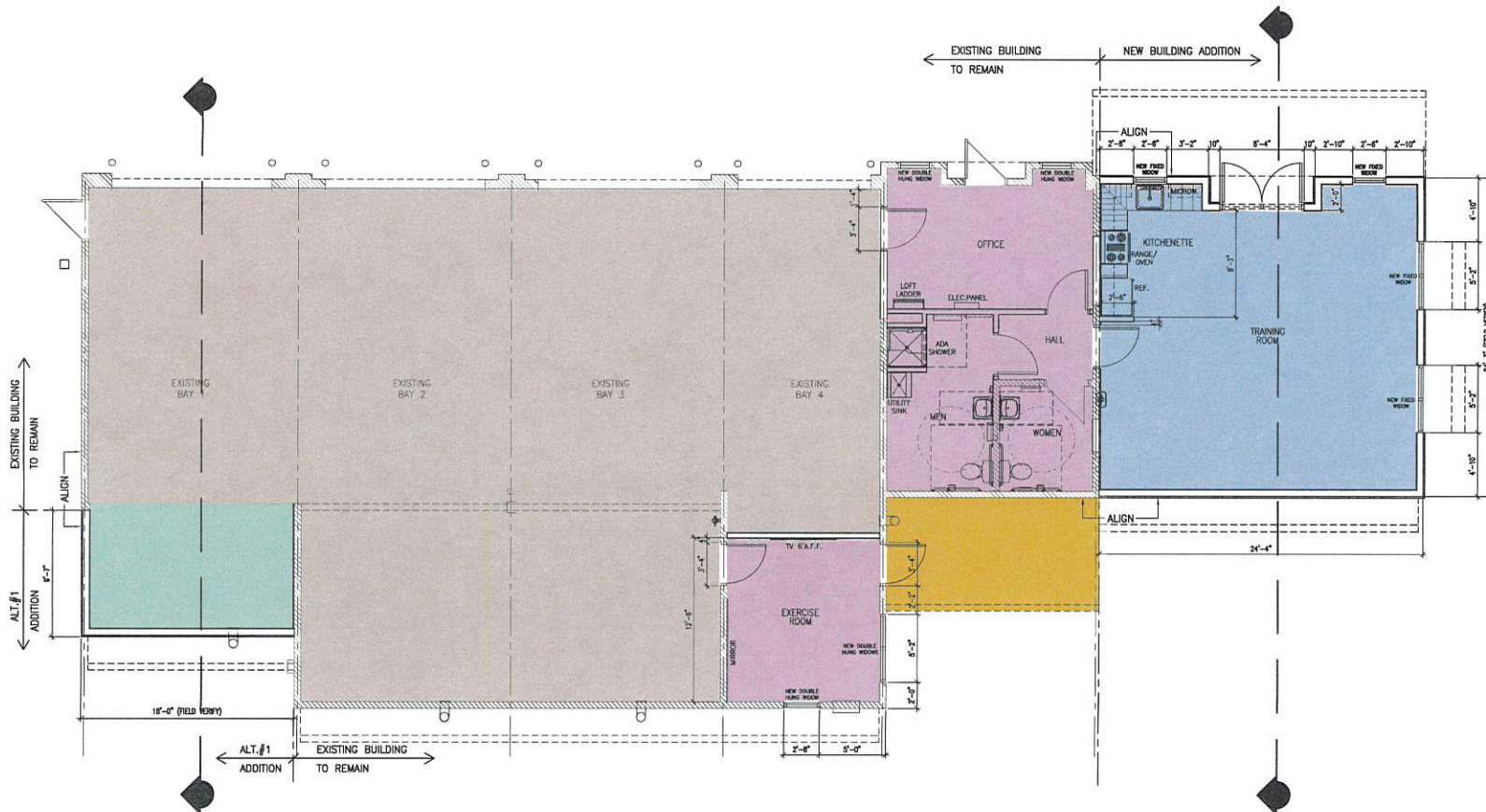

FLOOR PLAN

SCALE: 1/4" = 1'-0"



1306 RIO GRANDE BLVD NW
ALBUQUERQUE, NM 87104
505-254-6400 505-265-0154 FAX
WWW.NCA-ARCHITECTS.COM

SANTA FE
COUNTY
MADRID FIRE
STATION

JULY 2018



FLOOR
PLAN